

BID TABULATION FOR:

CONSTRUCTION OF PAVING AND APPURTENANCES
TO SERVE TAMARRON SECTION 21
FORT BEND COUNTY MUNICIPAL UTILITY DISTRICT NO. 182
CITY OF FULSHEAR E.T.J., FORT BEND COUNTY, TEXAS
SEPTEMBER 17, 2020
LJA ENGINEERING, INC.
D. FORREST
SEPTEMBER 17, 2020
1931-6021B (9.2)

BID OPENING DATE:
BID OPENING LOCATION:
TABULATION BY:
TABULATION DATE:
LJA JOB NO.

BIDDER'S NAME	TOTAL AMOUNT BID
1) R CONSTRUCTION CIVIL	\$1,283,351.65
2) D&J CONSTRUCTION, INC	\$1,525,389.15
3) BEYER CONSTRUCTION, LLC	\$1,551,866.30
4) TRIPLE B SERVICES, LLP	\$1,583,564.12
5) HARRIS CONSTRUCTION COMPANY, LTD.	\$1,595,788.95
6) DACO PAVING, INC.	\$1,670,606.65

CALENDAR DAYS - 70/60

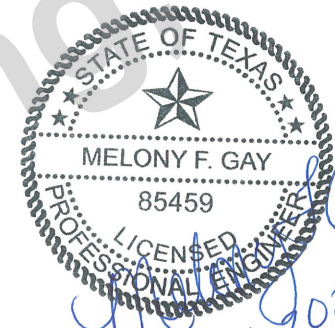

Melony Gay

I, Melony F. Gay, P.E., hereby certify these bid tabulations to be true and correct.

BID TABULATION FOR:

BID OPENING DATE:
BID OPENING LOCATION:
TABULATION BY:
TABULATION DATE:
LJA JOB NO.

CONSTRUCTION OF PAVING AND APPURTENANCES
 TO SERVE TAMARRON SECTION 21
 FORT BEND COUNTY MUNICIPAL UTILITY DISTRICT NO. 182
 CITY OF FULSHEAR E.T.J., FORT BEND COUNTY, TEXAS
 SEPTEMBER 17, 2020
 LJA ENGINEERING, INC.
 D. FORREST
 SEPTEMBER 17, 2020
 1931-6021B (9.2)

ITEM	DESCRIPTION	UNIT	QTY	1) R CONSTRUCTION CIVIL		2) D&J CONSTRUCTION, INC		3) BEYER CONSTRUCTION, LLC	
				UNIT COST	TOTAL COST	UNIT COST	TOTAL COST	UNIT COST	TOTAL COST
PAVING AND APPURTENANCES ITEMS									
1	6" REINFORCED CONCRETE PAVEMENT, COMPLETE IN PLACE	SY	17766	\$35.00	\$621,810.00	\$37.25	\$661,783.50	\$38.95	\$691,985.70
2	7" REINFORCED CONCRETE PAVEMENT, COMPLETE IN PLACE	SY	2420	\$40.00	\$96,800.00	\$41.25	\$99,825.00	\$42.75	\$103,455.00
3	6" REINFORCED CONCRETE CURB, COMPLETE IN PLACE	LF	3266	\$3.00	\$9,798.00	\$3.25	\$10,614.50	\$3.75	\$12,247.50
4	4"X12" REINFORCED CONCRETE CURB, COMPLETE IN PLACE	LF	7194	\$3.00	\$21,582.00	\$3.25	\$23,380.50	\$3.75	\$26,977.50
5	6" LIME/FLY ASH STABILIZED SUBGRADE MANIPULATION, INCLUDES COMPACTION TO 95% STANDARD PROCTOR DENSITY, COMPLETE IN PLACE	SY	19847	\$2.25	\$44,655.75	\$2.25	\$44,655.75	\$2.70	\$53,586.90
6	3% LIME BY WEIGHT, 14LB/SY FOR SUBGRADE, QUANTITY TO BE PAID ONLY FOR FIELD LAB RECOMMENDED QUANTITY, COMPLETE IN PLACE	TON	138.9	\$180.00	\$25,002.00	\$200.00	\$27,780.00	\$185.00	\$25,696.50
7	7% FLY ASH BY WEIGHT, 32LB/SY FOR SUBGRADE, QUANTITY TO BE PAID ONLY FOR FIELD LAB RECOMMENDED QUANTITY, COMPLETE IN PLACE	TON	317.6	\$90.00	\$28,584.00	\$98.00	\$31,124.80	\$85.00	\$26,996.00
8	8" LIME/FLY ASH STABILIZED SUBGRADE MANIPULATION, INCLUDES COMPACTION TO 95% STANDARD PROCTOR DENSITY, COMPLETE IN PLACE	SY	2759	\$2.50	\$6,897.50	\$2.50	\$6,897.50	\$3.00	\$8,277.00
9	3% LIME BY WEIGHT, 19LB/SY FOR SUBGRADE, QUANTITY TO BE PAID ONLY FOR FIELD LAB RECOMMENDED QUANTITY, COMPLETE IN PLACE	TON	26.2	\$180.00	\$4,716.00	\$200.00	\$5,240.00	\$185.00	\$4,847.00
10	7% FLY ASH BY WEIGHT, 43LB/SY FOR SUBGRADE, QUANTITY TO BE PAID ONLY FOR FIELD LAB RECOMMENDED QUANTITY, COMPLETE IN PLACE	TON	59.3	\$90.00	\$5,337.00	\$98.00	\$5,811.40	\$85.00	\$5,040.50
11	6" REINFORCED CONCRETE PAVEMENT, FOR WATER WELL ACCESS ROAD, COMPLETE IN PLACE	SY	100	\$35.00	\$3,500.00	\$50.00	\$5,000.00	\$99.75	\$9,975.00
12	6" LIME/FLY ASH STABILIZED SUBGRADE MANIPULATION, FOR WATER WELL ACCESS ROAD, INCLUDES COMPACTION TO 95% STANDARD PROCTOR DENSITY, COMPLETE IN PLACE	SY	134	\$2.50	\$335.00	\$5.00	\$670.00	\$2.50	\$335.00
13	3% LIME BY WEIGHT, 14LB/SY FOR SUBGRADE, FOR WATER WELL ACCESS ROAD, QUANTITY TO BE PAID ONLY FOR FIELD LAB RECOMMENDED QUANTITY, COMPLETE IN PLACE	TON	0.94	\$180.00	\$169.20	\$1,000.00	\$940.00	\$185.00	\$173.90
14	7% FLY ASH BY WEIGHT, 32LB/SY FOR SUBGRADE, FOR WATER WELL ACCESS ROAD, QUANTITY TO BE PAID ONLY FOR FIELD LAB RECOMMENDED QUANTITY, COMPLETE IN PLACE	TON	2.15	\$90.00	\$193.50	\$200.00	\$430.00	\$85.00	\$182.75
15	6" CRUSHED CONCRETE WITH GEOFABRIC (MIRAFI 500 OR APPROVED EQUAL) FOR WATER WELL ACCESS ROAD, COMPLETE IN PLACE	SY	2045	\$12.00	\$24,540.00	\$21.00	\$42,945.00	\$19.00	\$38,855.00
16	1.5" SEWER ROCK ON TOP OF PROPOSED 6" CRUSHED CONCRETE, ALL ROCK, TO BE BETWEEN 0.5" AND 1.5" ROCK, AS DIRECTED BY THE ENGINEER, COMPLETE IN PLACE	SY	2045	\$7.00	\$14,315.00	\$7.00	\$14,315.00	\$4.00	\$8,180.00
17	8" LIME/FLY ASH STABILIZED SUBGRADE MANIPULATION, FOR CRUSHED CONCRETE ACCESS ROAD, INCLUDES COMPACTION TO 95% STANDARD PROCTOR DENSITY, COMPLETE IN PLACE	SY	2249	\$2.50	\$5,622.50	\$3.00	\$6,747.00	\$3.50	\$7,871.50
18	3% LIME BY WEIGHT, 19LB/SY FOR SUBGRADE, FOR CRUSHED CONCRETE ACCESS ROAD, QUANTITY TO BE PAID ONLY FOR FIELD LAB RECOMMENDED QUANTITY, COMPLETE IN PLACE	TON	21.4	\$180.00	\$3,852.00	\$250.00	\$5,350.00	\$185.00	\$3,959.00
19	7% FLY ASH BY WEIGHT, 43LB/SY FOR SUBGRADE, FOR CRUSHED CONCRETE ACCESS ROAD, QUANTITY TO BE PAID ONLY FOR FIELD LAB RECOMMENDED QUANTITY, COMPLETE IN PLACE	TON	48.4	\$90.00	\$4,356.00	\$115.00	\$5,566.00	\$85.00	\$4,114.00

BID TABULATION FOR:

BID OPENING DATE:
BID OPENING LOCATION:
TABULATION BY:
TABULATION DATE:
LJA JOB NO.

CONSTRUCTION OF PAVING AND APPURTENANCES
 TO SERVE TAMARRON SECTION 21
 FORT BEND COUNTY MUNICIPAL UTILITY DISTRICT NO. 182
 CITY OF FULSHEAR E.T.J., FORT BEND COUNTY, TEXAS
 SEPTEMBER 17, 2020
 LJA ENGINEERING, INC.
 D. FORREST
 SEPTEMBER 17, 2020
 1931-6021B (9.2)

ITEM	DESCRIPTION	UNIT	QTY	1) R CONSTRUCTION CIVIL		2) D&J CONSTRUCTION, INC		3) BEYER CONSTRUCTION, LLC	
				UNIT COST	TOTAL COST	UNIT COST	TOTAL COST	UNIT COST	TOTAL COST
20	ZERO LOAD SLAB FOR TEXAS ILLINOIS NATURAL GAS PIPELINE CROSSING, PER KINDER MORGAN REQUIREMENTS AND DETAIL ON SHEET 29, INCLUDING CEMENT STABILIZED SAND TO THE BOTTOM OF THE SUBGRADE, COMPLETE IN PLACE	SY	94	\$190.00	\$17,860.00	\$225.00	\$21,150.00	\$440.00	\$41,360.00
21	REMOVE AND REPLACE EXISTING 8" PAVEMENT WITH 8" LIME/FLY ASH SUBGRADE AT YELLOWSTONE PRESERVE DRIVE, INCLUDES 6" CURB AND ALL APPURTENANCES, AS NECESSARY, AS DIRECTED BY THE ENGINEER, COMPLETE IN PLACE	SY	90	\$100.00	\$9,000.00	\$125.00	\$11,250.00	\$120.00	\$10,800.00
22	REMOVE AND DISPOSE EXISTING 8' TALL WOOD FENCE, INCLUDING ALL APPURTENANCES, AS NECESSARY, AS DIRECTED BY THE ENGINEER, COMPLETE IN PLACE	LF	35	\$10.00	\$350.00	\$30.00	\$1,050.00	\$30.00	\$1,050.00
23	INSTALL 8' TALL SWING GATE, MATCH EXISTING LIFT STATION FENCE, INCLUDES ALL APPURTENANCES, COMPLETE IN PLACE	LF	22	\$150.00	\$3,300.00	\$125.00	\$2,750.00	\$154.00	\$3,388.00
24	8' TALL WOOD FENCE, INCLUDING ALL APPURTENANCES, AS NECESSARY, AS DIRECTED BY THE ENGINEER, COMPLETE IN PLACE	LF	14	\$150.00	\$2,100.00	\$110.00	\$1,540.00	\$99.50	\$1,393.00
25	ALLOWANCE FOR REMOVAL EXISTING LANDSCAPING AND IRRIGATION AT PROPOSED REMOTE WATER WELL ACCESS ROAD GATE, INCLUDES IRRIGATION SLEEVES AS NECESSARY, CONTACT BEN COLLINS AT CHAMPIONS HYDROLAWN @ 832-977-2198, AS DIRECTED BY THE ENGINEER, COMPLETE IN PLACE	LS	1	\$3,500.00	\$3,500.00	\$3,500.00	\$3,500.00	\$3,500.00	\$3,500.00
26	FINAL LOT GRADING, INCLUDING STRIPPING AND PROOFROLLING, HAULING, PLACEMENT AND COMPACTION OF MATERIALS AND REPLACEMENT OF STRIPPINGS, COMPLETE IN PLACE	EA	142	\$125.00	\$17,750.00	\$125.00	\$17,750.00	\$200.00	\$28,400.00
27	LIGHT CLEARING AND GRUBBING OF ADJACENT DRILL SITE, AS DIRECTED BY THE ENGINEER, COMPLETE IN PLACE	AC	2.99	\$500.00	\$1,495.00	\$2,500.00	\$7,475.00	\$500.00	\$1,495.00
28	ON-SITE DIRT EXCAVATION AND MANIPULATION TO BE HAULED, STRIPPED, PLACED, AND COMPACTED TO 95% STANDARD PROCTOR DENSITY ON ADJACENT DRILL SITE TO ENSURE POSITIVE DRAINAGE TO PROPOSED SWALES, AS DIRECTED BY THE ENGINEER, COMPLETE IN PLACE	CY	778	\$3.00	\$2,334.00	\$5.00	\$3,890.00	\$4.00	\$3,112.00
29	ON-SITE DIRT EXCAVATION AND MANIPULATION TO BE HAULED, STRIPPED, PLACED, AND COMPACTED TO 95% STANDARD PROCTOR DENSITY ON-SITE FOR LOT FILL, AS DIRECTED BY ENGINEER, COMPLETE IN PLACE	CY	22040	\$1.00	\$22,040.00	\$3.50	\$77,140.00	\$4.00	\$88,160.00
30	UTILITY SPOILS TO BE USED FOR LOT FILL, INCLUDES HAULING, PLACING, AND COMPACTING TO 95% STANDARD PROCTOR DENSITY WITH MAXIMUM 8" LIFTS, AS DIRECTED BY ENGINEER, COMPLETE IN PLACE	CY	11006	\$2.50	\$27,515.00	\$3.50	\$38,521.00	\$4.00	\$44,024.00
31	6' WHEELCHAIR RAMPS (TYPE 7), INCLUDING TRUNCATED DOME BRICKS TO BE STAINED WITH CONTRASTING COLOR PER THE EXISTING WHEELCHAIR RAMPS LOCATED WITHIN SUBDIVISION, INCLUDES REMOVAL OF EXISTING CURB IF REQUIRED AND ALL OTHER APPURTENANCES, COMPLETE IN PLACE	EA	22	\$1,250.00	\$27,500.00	\$1,200.00	\$26,400.00	\$1,200.00	\$26,400.00
32	PERMANENT TRAFFIC CONTROL DEVICES, INCLUDING TRAFFIC BUTTONS, PAVEMENT STRIPING, MARKERS, REFLECTIVE PAINT ON MEDIAN NOSES, STOP SIGNS, STREET SIGNS, AND ALL OTHER TRAFFIC SIGNS SHOWN IN PLANS, ETC., COMPLETE IN PLACE	LS	1	\$10,000.00	\$10,000.00	\$14,000.00	\$14,000.00	\$12,000.00	\$12,000.00
33	4" SQUARE DOUBLE REFLECTORIZED BLUE TRAFFIC BUTTONS FOR FIRE HYDRANT LOCATION, COMPLETE IN PLACE	EA	13	\$6.00	\$78.00	\$10.00	\$130.00	\$4.90	\$63.70
34	24" SOD STRIPING ALONG BACK OF CURB, COMPLETE IN PLACE	LF	10460	\$0.50	\$5,230.00	\$1.00	\$10,460.00	\$0.50	\$5,230.00
35	LIGHT CLEARING, GRUBBING, AND STRIPPING, TO BE USED ONLY AS DIRECTED BY THE ENGINEER, COMPLETE IN PLACE	AC	10	\$1,100.00	\$11,000.00	\$2,500.00	\$25,000.00	\$1,100.00	\$11,000.00

BID TABULATION FOR:

BID OPENING DATE:
BID OPENING LOCATION:
TABULATION BY:
TABULATION DATE:
LJA JOB NO.

CONSTRUCTION OF PAVING AND APPURTENANCES
 TO SERVE TAMARRON SECTION 21
 FORT BEND COUNTY MUNICIPAL UTILITY DISTRICT NO. 182
 CITY OF FULSHEAR E.T.J., FORT BEND COUNTY, TEXAS
 SEPTEMBER 17, 2020
 LJA ENGINEERING, INC.
 D. FORREST
 SEPTEMBER 17, 2020
 1931-6021B (9.2)

ITEM	DESCRIPTION	UNIT	QTY	1) R CONSTRUCTION CIVIL		2) D&J CONSTRUCTION, INC		3) BEYER CONSTRUCTION, LLC	
				UNIT COST	TOTAL COST	UNIT COST	TOTAL COST	UNIT COST	TOTAL COST
36	BROADCAST SEEDING, FERTILIZING AND WATERING, ALL DISTURBED AREAS, AS DIRECTED BY ENGINEER, COMPLETE IN PLACE	AC	31.94	\$550.00	\$17,567.00	\$1,000.00	\$31,940.00	\$200.00	\$6,388.00
37	6" P.V.C. SCHEDULE 40 IRRIGATION SLEEVES, AS DIRECTED BY THE ENGINEER, COMPLETE IN PLACE	LF	159	\$20.00	\$3,180.00	\$15.00	\$2,385.00	\$23.00	\$3,657.00
38	10" P.V.C. SCHEDULE 40 IRRIGATION SLEEVES, AS DIRECTED BY THE ENGINEER, COMPLETE IN PLACE	LF	170	\$30.00	\$5,100.00	\$35.00	\$5,950.00	\$26.00	\$4,420.00
39	INSTALLATION, MAINTENANCE, AND REMOVAL OF REINFORCED FILTER FABRIC FENCE, 2 FEET OFF OF B.O.C., (TO BE USED ONLY AS DIRECTED BY THE ENGINEER), COMPLETE IN PLACE	LF	10460	\$1.60	\$16,736.00	\$2.00	\$20,920.00	\$1.60	\$16,736.00
40	MAINTENANCE AND REMOVAL OF REINFORCED FILTER FABRIC FENCE ALONG BOUNDARY OF PROJECT, (TO BE USED ONLY AS DIRECTED BY THE ENGINEER), COMPLETE IN PLACE	LF	5972	\$1.60	\$9,555.20	\$1.60	\$9,555.20	\$1.60	\$9,555.20
41	SILT FENCE INLET PROTECTION BARRIERS, SWMHCA SPECIFICATION NO.4511, FOR EXISTING INLETS, (TO BE USED ONLY AS DIRECTED BY THE ENGINEER), COMPLETE IN PLACE	EA	16	\$10.00	\$160.00	\$100.00	\$1,600.00	\$10.00	\$160.00
42	REMOVE AND DISPOSE OF EXISTING TYPE III BARRICADE, ONLY AS DIRECTED BY THE ENGINEER, COMPLETE IN PLACE	EA	4	\$1.00	\$4.00	\$200.00	\$800.00	\$35.00	\$140.00
43	STABILIZED CONSTRUCTION EXIT, TO BE REMOVED UPON COMPLETION, TO BE USED ONLY AS DIRECTED BY THE ENGINEER COMPLETE IN PLACE	EA	2	\$800.00	\$1,600.00	\$1,700.00	\$3,400.00	\$1,500.00	\$3,000.00
44	INSTALLATION AND REMOVAL UPON COMPLETION OF CONCRETE WASHOUT AREA, COMPLETE IN PLACE	EA	2	\$250.00	\$500.00	\$1,200.00	\$2,400.00	\$2,000.00	\$4,000.00
45	3:1 DRAINAGE SWALES, PER GRADING PLAN, INCLUDES HYDROMULCH SEEDING AND WATERING, COMPLETE IN PLACE	LF	1159	\$4.00	\$4,636.00	\$6.00	\$6,954.00	\$4.00	\$4,636.00
46	MISCELLANEOUS DRAINAGE SWALES, V BOTTOM, GRADED TO DRAIN, INCLUDES HYDROMULCH SEEDING AND WATERING, AS DIRECTED BY ENGINEER, COMPLETE IN PLACE	LF	1000	\$4.00	\$4,000.00	\$5.00	\$5,000.00	\$4.00	\$4,000.00
47	10' BOTTOM OVERFLOW SWALES, PER GRADING PLAN, AS DIRECTED BY THE ENGINEER, COMPLETE IN PLACE	SY	949	\$4.00	\$3,796.00	\$7.00	\$6,643.00	\$4.85	\$4,602.65
48	INSTALL AND MAINTAIN SOD WITH 6" GALVANIZED SOD STAPLES PLACED EVERY 3', INCLUDES REMOVAL OF STAPLES AT DIRECTION OF THE ENGINEER, COMPLETE IN PLACE	SY	1000	\$4.50	\$4,500.00	\$6.50	\$6,500.00	\$5.00	\$5,000.00
49	OVER EXCAVATION OF UNSUITABLE MATERIAL FOR FILL PLACEMENT, AS DIRECTED BY ENGINEER, COMPLETE IN PLACE	CY	4000	\$3.00	\$12,000.00	\$4.00	\$16,000.00	\$3.00	\$12,000.00
50	CEMENT STABILIZED SAND (TO BE USED ONLY AS DIRECTED BY THE ENGINEER), COMPLETE IN PLACE	CY	750	\$1.00	\$750.00	\$40.00	\$30,000.00	\$25.00	\$18,750.00
51	5' REINFORCED CONCRETE SIDEWALK, AS DIRECTED BY ENGINEER, COMPLETE IN PLACE	LF	2820	\$25.00	\$70,500.00	\$23.00	\$64,860.00	\$33.00	\$93,060.00
52	REMOVE AND REPLACE 5' REINFORCED CONCRETE SIDEWALK ALONG TAMARRON TRACE, AS NECESSARY, AS DIRECTED BY THE ENGINEER, COMPLETE IN PLACE	LF	500	\$40.00	\$20,000.00	\$40.00	\$20,000.00	\$40.00	\$20,000.00
53	REINSPECTION FEE, PER FORT BEND COUNTY REQUIREMENTS, AS NEEDED, COMPLETE IN PLACE	EA	1	\$500.00	\$500.00	\$500.00	\$500.00	\$500.00	\$500.00
54	REINSPECTION FEE DUE TO EXCEEDING 60-DAY TIME PERIOD, PER FORT BEND COUNTY REQUIREMENTS, AS NEEDED, COMPLETE IN PLACE	EA	1	\$1,000.00	\$1,000.00	\$1,000.00	\$1,000.00	\$1,000.00	\$1,000.00

BID TABULATION FOR:

BID OPENING DATE:
BID OPENING LOCATION:
TABULATION BY:
TABULATION DATE:
LJA JOB NO.

CONSTRUCTION OF PAVING AND APPURTENANCES
 TO SERVE TAMARRON SECTION 21
 FORT BEND COUNTY MUNICIPAL UTILITY DISTRICT NO. 182
 CITY OF FULSHEAR E.T.J., FORT BEND COUNTY, TEXAS
 SEPTEMBER 17, 2020
 LJA ENGINEERING, INC.
 D. FORREST
 SEPTEMBER 17, 2020
 1931-6021B (9.2)

ITEM	DESCRIPTION	UNIT	QTY	1) R CONSTRUCTION CIVIL		2) D&J CONSTRUCTION, INC		3) BEYER CONSTRUCTION, LLC	
				UNIT COST	TOTAL COST	UNIT COST	TOTAL COST	UNIT COST	TOTAL COST
55	METHOD "A" CONSTRUCTION STAKING BY THE CONTRACTOR PER GBI PARTNERS, LP, 281.499.4539, COMPLETE IN PLACE	LS	1	\$10,000.00	\$10,000.00	\$11,500.00	\$11,500.00	\$10,000.00	\$10,000.00
56	AS-BUILT FINAL LOT GRADING SURVEY BY THE CONTRACTOR, INCLUDING BERM, SWALES, AND ALL FILL AREAS, PER GBI PARTNERS, LP, 281.499.4539, COMPLETE IN PLACE	LS	1	\$3,000.00	\$3,000.00	\$3,500.00	\$3,500.00	\$3,000.00	\$3,000.00
57	CITY OF FULSHEAR INSPECTION FEE, 0.75% OF THE TOTAL CONSTRUCTION COST, COMPLETE IN PLACE	LS	1	\$9,650.00	\$9,650.00	\$11,400.00	\$11,400.00	\$11,630.00	\$11,630.00
58	ALLOWANCE FOR FORT BEND COUNTY PERMIT FOR WORK INSIDE RIGHT OF WAY, AS NECESSARY, COMPLETE IN PLACE	EA	3	\$500.00	\$1,500.00	\$500.00	\$1,500.00	\$500.00	\$1,500.00
PAVING AND APPURTENANCES ITEMS SUBTOTAL:					\$1,283,351.65	\$1,283,351.65	\$1,525,389.15	\$1,525,389.15	\$1,551,866.30
<u>BIDDING SUMMARY</u>									
SUBTOTAL PAVING AND APPURTENANCES ITEMS					\$1,283,351.65	\$1,283,351.65	\$1,525,389.15	\$1,525,389.15	\$1,551,866.30
TOTAL AMOUNT BASE BID					\$1,283,351.65	\$1,283,351.65	\$1,525,389.15	\$1,525,389.15	\$1,551,866.30

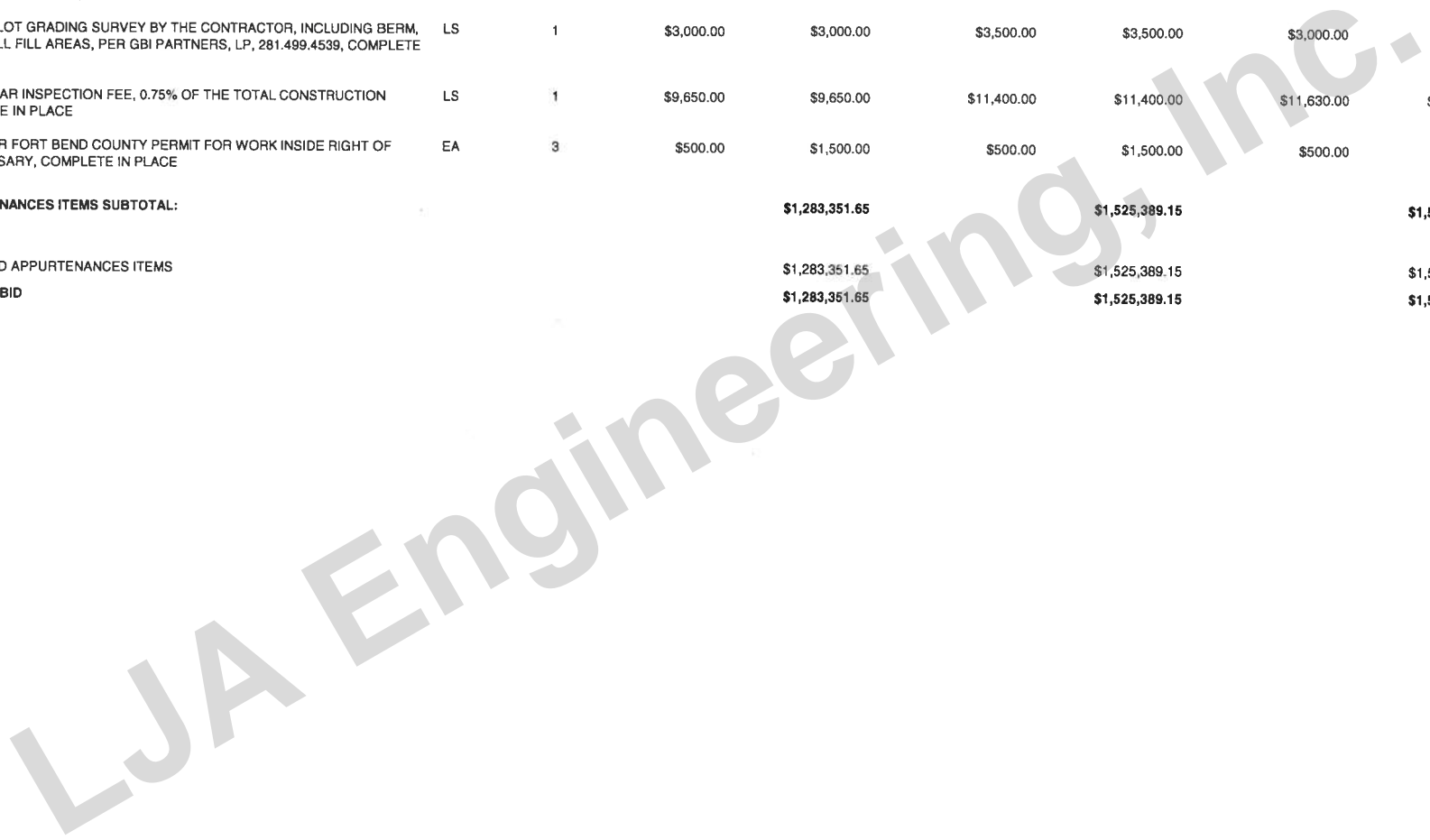

BID TABULATION FOR:

BID OPENING DATE:
BID OPENING LOCATION:
TABULATION BY:
TABULATION DATE:
LJA JOB NO.

CONSTRUCTION OF PAVING AND APPURTENANCES
 TO SERVE TAMARRON SECTION 21
 FORT BEND COUNTY MUNICIPAL UTILITY DISTRICT NO. 182
 CITY OF FULSHEAR E.T.J., FORT BEND COUNTY, TEXAS
 SEPTEMBER 17, 2020
 LJA ENGINEERING, INC.
 D. FORREST
 SEPTEMBER 17, 2020
 1931-6021B (9.2)

ITEM	DESCRIPTION	UNIT	QTY	4) TRIPLE B SERVICES, LLP		5) HARRIS CONSTRUCTION COMPANY, LTD.		6) DACO PAVING, INC.	
				UNIT COST	TOTAL COST	UNIT COST	TOTAL COST	UNIT COST	TOTAL COST
PAVING AND APPURTENANCES ITEMS									
1	6" REINFORCED CONCRETE PAVEMENT, COMPLETE IN PLACE	SY	17766	\$38.00	\$675,108.00	\$37.00	\$657,342.00	\$38.00	\$675,108.00
2	7" REINFORCED CONCRETE PAVEMENT, COMPLETE IN PLACE	SY	2420	\$43.00	\$104,060.00	\$42.00	\$101,640.00	\$42.00	\$101,640.00
3	6" REINFORCED CONCRETE CURB, COMPLETE IN PLACE	LF	3266	\$4.00	\$13,064.00	\$2.95	\$9,634.70	\$3.30	\$10,777.80
4	4"X12" REINFORCED CONCRETE CURB, COMPLETE IN PLACE	LF	7194	\$4.00	\$28,776.00	\$2.95	\$21,222.30	\$3.30	\$23,740.20
5	6" LIME/FLY ASH STABILIZED SUBGRADE MANIPULATION, INCLUDES COMPACTION TO 95% STANDARD PROCTOR DENSITY, COMPLETE IN PLACE	SY	19847	\$3.00	\$59,541.00	\$2.00	\$39,694.00	\$3.00	\$59,541.00
6	3% LIME BY WEIGHT, 14LB/SY FOR SUBGRADE, QUANTITY TO BE PAID ONLY FOR FIELD LAB RECOMMENDED QUANTITY, COMPLETE IN PLACE	TON	138.9	\$188.00	\$26,113.20	\$210.00	\$29,169.00	\$190.00	\$26,391.00
7	7% FLY ASH BY WEIGHT, 32LB/SY FOR SUBGRADE, QUANTITY TO BE PAID ONLY FOR FIELD LAB RECOMMENDED QUANTITY, COMPLETE IN PLACE	TON	317.6	\$92.00	\$29,219.20	\$105.00	\$33,348.00	\$85.00	\$26,996.00
8	8" LIME/FLY ASH STABILIZED SUBGRADE MANIPULATION, INCLUDES COMPACTION TO 95% STANDARD PROCTOR DENSITY, COMPLETE IN PLACE	SY	2759	\$4.00	\$11,036.00	\$2.20	\$6,069.80	\$3.00	\$8,277.00
9	3% LIME BY WEIGHT, 19LB/SY FOR SUBGRADE, QUANTITY TO BE PAID ONLY FOR FIELD LAB RECOMMENDED QUANTITY, COMPLETE IN PLACE	TON	26.2	\$188.00	\$4,925.60	\$210.00	\$5,502.00	\$190.00	\$4,978.00
10	7% FLY ASH BY WEIGHT, 43LB/SY FOR SUBGRADE, QUANTITY TO BE PAID ONLY FOR FIELD LAB RECOMMENDED QUANTITY, COMPLETE IN PLACE	TON	59.3	\$92.00	\$5,455.60	\$105.00	\$6,226.50	\$85.00	\$5,040.50
11	6" REINFORCED CONCRETE PAVEMENT, FOR WATER WELL ACCESS ROAD, COMPLETE IN PLACE	SY	100	\$39.00	\$3,900.00	\$75.00	\$7,500.00	\$135.00	\$13,500.00
12	6" LIME/FLY ASH STABILIZED SUBGRADE MANIPULATION, FOR WATER WELL ACCESS ROAD, INCLUDES COMPACTION TO 95% STANDARD PROCTOR DENSITY, COMPLETE IN PLACE	SY	134	\$5.00	\$670.00	\$2.00	\$268.00	\$7.00	\$938.00
13	3% LIME BY WEIGHT, 14LB/SY FOR SUBGRADE, FOR WATER WELL ACCESS ROAD, QUANTITY TO BE PAID ONLY FOR FIELD LAB RECOMMENDED QUANTITY, COMPLETE IN PLACE	TON	0.94	\$188.00	\$176.72	\$210.00	\$197.40	\$190.00	\$178.60
14	7% FLY ASH BY WEIGHT, 32LB/SY FOR SUBGRADE, FOR WATER WELL ACCESS ROAD, QUANTITY TO BE PAID ONLY FOR FIELD LAB RECOMMENDED QUANTITY, COMPLETE IN PLACE	TON	2.15	\$92.00	\$197.80	\$105.00	\$225.75	\$85.00	\$182.75
15	6" CRUSHED CONCRETE WITH GEOFABRIC (MIRAFI 500 OR APPROVED EQUAL) FOR WATER WELL ACCESS ROAD, COMPLETE IN PLACE	SY	2045	\$15.00	\$30,675.00	\$24.00	\$49,080.00	\$26.00	\$53,170.00
16	1.5" SEWER ROCK ON TOP OF PROPOSED 6" CRUSHED CONCRETE, ALL ROCK, TO BE BETWEEN 0.5" AND 1.5" ROCK, AS DIRECTED BY THE ENGINEER, COMPLETE IN PLACE	SY	2045	\$8.00	\$16,360.00	\$10.00	\$20,450.00	\$11.00	\$22,495.00
17	8" LIME/FLY ASH STABILIZED SUBGRADE MANIPULATION, FOR CRUSHED CONCRETE ACCESS ROAD, INCLUDES COMPACTION TO 95% STANDARD PROCTOR DENSITY, COMPLETE IN PLACE	SY	2249	\$3.00	\$6,747.00	\$2.20	\$4,947.80	\$3.00	\$6,747.00
18	3% LIME BY WEIGHT, 19LB/SY FOR SUBGRADE, FOR CRUSHED CONCRETE ACCESS ROAD, QUANTITY TO BE PAID ONLY FOR FIELD LAB RECOMMENDED QUANTITY, COMPLETE IN PLACE	TON	21.4	\$188.00	\$4,023.20	\$210.00	\$4,494.00	\$190.00	\$4,066.00
19	7% FLY ASH BY WEIGHT, 43LB/SY FOR SUBGRADE, FOR CRUSHED CONCRETE ACCESS ROAD, QUANTITY TO BE PAID ONLY FOR FIELD LAB RECOMMENDED QUANTITY, COMPLETE IN PLACE	TON	48.4	\$92.00	\$4,452.80	\$105.00	\$5,082.00	\$85.00	\$4,114.00

BID TABULATION FOR:

BID OPENING DATE:
BID OPENING LOCATION:
TABULATION BY:
TABULATION DATE:
LJA JOB NO.

CONSTRUCTION OF PAVING AND APPURTENANCES
 TO SERVE TAMARRON SECTION 21
 FORT BEND COUNTY MUNICIPAL UTILITY DISTRICT NO. 182
 CITY OF FULSHEAR E.T.J., FORT BEND COUNTY, TEXAS
 SEPTEMBER 17, 2020
 LJA ENGINEERING, INC.
 D. FORREST
 SEPTEMBER 17, 2020
 1931-6021B (9.2)

ITEM	DESCRIPTION	UNIT	QTY	4) TRIPLE B SERVICES, LLP		5) HARRIS CONSTRUCTION COMPANY, LTD.		6) DACO PAVING, INC.	
				UNIT COST	TOTAL COST	UNIT COST	TOTAL COST	UNIT COST	TOTAL COST
20	ZERO LOAD SLAB FOR TEXAS ILLINOIS NATURAL GAS PIPELINE CROSSING, PER KINDER MORGAN REQUIREMENTS AND DETAIL ON SHEET 29, INCLUDING CEMENT STABILIZED SAND TO THE BOTTOM OF THE SUBGRADE, COMPLETE IN PLACE	SY	94	\$103.00	\$9,682.00	\$475.00	\$44,650.00	\$250.00	\$23,500.00
21	REMOVE AND REPLACE EXISTING 8" PAVEMENT WITH 8" LIME/FLY ASH SUBGRADE AT YELLOWSTONE PRESERVE DRIVE, INCLUDES 6" CURB AND ALL APPURTENANCES, AS NECESSARY, AS DIRECTED BY THE ENGINEER, COMPLETE IN PLACE	SY	90	\$105.00	\$9,450.00	\$225.00	\$20,250.00	\$150.00	\$13,500.00
22	REMOVE AND DISPOSE EXISTING 8' TALL WOOD FENCE, INCLUDING ALL APPURTENANCES, AS NECESSARY, AS DIRECTED BY THE ENGINEER, COMPLETE IN PLACE	LF	35	\$11.00	\$385.00	\$135.00	\$4,725.00	\$15.00	\$525.00
23	INSTALL 8' TALL SWING GATE, MATCH EXISTING LIFT STATION FENCE, INCLUDES ALL APPURTENANCES, COMPLETE IN PLACE	LF	22	\$157.00	\$3,454.00	\$250.00	\$5,500.00	\$200.00	\$4,400.00
24	8' TALL WOOD FENCE, INCLUDING ALL APPURTENANCES, AS NECESSARY, AS DIRECTED BY THE ENGINEER, COMPLETE IN PLACE	LF	14	\$124.00	\$1,736.00	\$125.00	\$1,750.00	\$80.00	\$1,120.00
25	ALLOWANCE FOR REMOVAL EXISTING LANDSCAPING AND IRRIGATION AT PROPOSED REMOTE WATER WELL ACCESS ROAD GATE, INCLUDES IRRIGATION SLEEVES AS NECESSARY, CONTACT BEN COLLINS AT CHAMPIONS HYDROLAWN @ 832-977-2198, AS DIRECTED BY THE ENGINEER, COMPLETE IN PLACE	LS	1	\$3,500.00	\$3,500.00	\$3,500.00	\$3,500.00	\$3,500.00	\$3,500.00
26	FINAL LOT GRADING, INCLUDING STRIPPING AND PROOFROLLING, HAULING, PLACEMENT AND COMPACTION OF MATERIALS AND REPLACEMENT OF STRIPPINGS, COMPLETE IN PLACE	EA	142	\$200.00	\$28,400.00	\$125.00	\$17,750.00	\$150.00	\$21,300.00
27	LIGHT CLEARING AND GRUBBING OF ADJACENT DRILL SITE, AS DIRECTED BY THE ENGINEER, COMPLETE IN PLACE	AC	2.99	\$4,920.00	\$14,710.80	\$3,500.00	\$10,465.00	\$2,000.00	\$5,980.00
28	ON-SITE DIRT EXCAVATION AND MANIPULATION TO BE HAULED, STRIPPED, PLACED, AND COMPACTED TO 95% STANDARD PROCTOR DENSITY ON ADJACENT DRILL SITE TO ENSURE POSITIVE DRAINAGE TO PROPOSED SWALES, AS DIRECTED BY THE ENGINEER, COMPLETE IN PLACE	CY	778	\$8.00	\$6,224.00	\$3.00	\$2,334.00	\$4.15	\$3,228.70
29	ON-SITE DIRT EXCAVATION AND MANIPULATION TO BE HAULED, STRIPPED, PLACED, AND COMPACTED TO 95% STANDARD PROCTOR DENSITY ON-SITE FOR LOT FILL, AS DIRECTED BY ENGINEER, COMPLETE IN PLACE	CY	22040	\$3.00	\$66,120.00	\$3.00	\$66,120.00	\$4.15	\$91,466.00
30	UTILITY SPOILS TO BE USED FOR LOT FILL, INCLUDES HAULING, PLACING, AND COMPACTING TO 95% STANDARD PROCTOR DENSITY WITH MAXIMUM 8' LIFTS, AS DIRECTED BY ENGINEER, COMPLETE IN PLACE	CY	11006	\$8.50	\$93,551.00	\$3.00	\$33,018.00	\$4.15	\$45,674.90
31	6' WHEELCHAIR RAMPS (TYPE 7), INCLUDING TRUNCATED DOME BRICKS TO BE STAINED WITH CONTRASTING COLOR PER THE EXISTING WHEELCHAIR RAMPS LOCATED WITHIN SUBDIVISION, INCLUDES REMOVAL OF EXISTING CURB IF REQUIRED AND ALL OTHER APPURTENANCES, COMPLETE IN PLACE	EA	22	\$1,350.00	\$29,700.00	\$1,225.00	\$26,950.00	\$1,200.00	\$26,400.00
32	PERMANENT TRAFFIC CONTROL DEVICES, INCLUDING TRAFFIC BUTTONS, PAVEMENT STRIPING, MARKERS, REFLECTIVE PAINT ON MEDIAN NOSES, STOP SIGNS, STREET SIGNS, AND ALL OTHER TRAFFIC SIGNS SHOWN IN PLANS, ETC., COMPLETE IN PLACE	LS	1	\$9,150.00	\$9,150.00	\$17,745.00	\$17,745.00	\$15,000.00	\$15,000.00
33	4" SQUARE DOUBLE REFLECTORIZED BLUE TRAFFIC BUTTONS FOR FIRE HYDRANT LOCATION, COMPLETE IN PLACE	EA	13	\$10.00	\$130.00	\$11.00	\$143.00	\$15.00	\$195.00
34	24" SOD STRIPING ALONG BACK OF CURB, COMPLETE IN PLACE	LF	10460	\$0.50	\$5,230.00	\$1.25	\$13,075.00	\$2.00	\$20,920.00
35	LIGHT CLEARING, GRUBBING, AND STRIPPING, TO BE USED ONLY AS DIRECTED BY THE ENGINEER, COMPLETE IN PLACE	AC	10	\$1,100.00	\$11,000.00	\$1,100.00	\$11,000.00	\$1,100.00	\$11,000.00

BID TABULATION FOR:

BID OPENING DATE:
BID OPENING LOCATION:
TABULATION BY:
TABULATION DATE:
LJA JOB NO.

CONSTRUCTION OF PAVING AND APPURTENANCES
 TO SERVE TAMARRON SECTION 21
 FORT BEND COUNTY MUNICIPAL UTILITY DISTRICT NO. 182
 CITY OF FULSHEAR E.T.J., FORT BEND COUNTY, TEXAS
 SEPTEMBER 17, 2020
 LJA ENGINEERING, INC.
 D. FORREST
 SEPTEMBER 17, 2020
 1931-6021B (9.2)

ITEM	DESCRIPTION	UNIT	QTY	4) TRIPLE B SERVICES, LLP		5) HARRIS CONSTRUCTION COMPANY, LTD.		6) DACO PAVING, INC.	
				UNIT COST	TOTAL COST	UNIT COST	TOTAL COST	UNIT COST	TOTAL COST
36	BROADCAST SEEDING, FERTILIZING AND WATERING, ALL DISTURBED AREAS, AS DIRECTED BY ENGINEER, COMPLETE IN PLACE	AC	31.94	\$850.00	\$27,149.00	\$825.00	\$26,350.50	\$1,000.00	\$31,940.00
37	6" P.V.C. SCHEDULE 40 IRRIGATION SLEEVES, AS DIRECTED BY THE ENGINEER, COMPLETE IN PLACE	LF	159	\$18.00	\$2,862.00	\$22.00	\$3,498.00	\$27.00	\$4,293.00
38	10" P.V.C. SCHEDULE 40 IRRIGATION SLEEVES, AS DIRECTED BY THE ENGINEER, COMPLETE IN PLACE	LF	170	\$27.00	\$4,590.00	\$32.00	\$5,440.00	\$35.00	\$5,950.00
39	INSTALLATION, MAINTENANCE, AND REMOVAL OF REINFORCED FILTER FABRIC FENCE, 2 FEET OFF OF B.O.C., (TO BE USED ONLY AS DIRECTED BY THE ENGINEER), COMPLETE IN PLACE	LF	10460	\$1.60	\$16,736.00	\$1.60	\$16,736.00	\$1.60	\$16,736.00
40	MAINTENANCE AND REMOVAL OF REINFORCED FILTER FABRIC FENCE ALONG BOUNDARY OF PROJECT, (TO BE USED ONLY AS DIRECTED BY THE ENGINEER), COMPLETE IN PLACE	LF	5972	\$1.60	\$9,555.20	\$1.60	\$9,555.20	\$1.60	\$9,555.20
41	SILT FENCE INLET PROTECTION BARRIERS, SWMHCA SPECIFICATION NO.4511, FOR EXISTING INLETS, (TO BE USED ONLY AS DIRECTED BY THE ENGINEER), COMPLETE IN PLACE	EA	16	\$58.00	\$928.00	\$50.00	\$800.00	\$120.00	\$1,920.00
42	REMOVE AND DISPOSE OF EXISTING TYPE III BARRICADE, ONLY AS DIRECTED BY THE ENGINEER, COMPLETE IN PLACE	EA	4	\$72.00	\$288.00	\$200.00	\$800.00	\$25.00	\$100.00
43	STABILIZED CONSTRUCTION EXIT, TO BE REMOVED UPON COMPLETION, TO BE USED ONLY AS DIRECTED BY THE ENGINEER COMPLETE IN PLACE	EA	2	\$2,300.00	\$4,600.00	\$2,500.00	\$5,000.00	\$1,500.00	\$3,000.00
44	INSTALLATION AND REMOVAL UPON COMPLETION OF CONCRETE WASHOUT AREA, COMPLETE IN PLACE	EA	2	\$285.00	\$570.00	\$1,000.00	\$2,000.00	\$800.00	\$1,600.00
45	3:1 DRAINAGE SWALES, PER GRADING PLAN, INCLUDES HYDROMULCH SEEDING AND WATERING, COMPLETE IN PLACE	LF	1159	\$4.00	\$4,636.00	\$4.00	\$4,636.00	\$4.00	\$4,636.00
46	MISCELLANEOUS DRAINAGE SWALES, V BOTTOM, GRADED TO DRAIN, INCLUDES HYDROMULCH SEEDING AND WATERING, AS DIRECTED BY ENGINEER, COMPLETE IN PLACE	LF	1000	\$4.00	\$4,000.00	\$4.00	\$4,000.00	\$4.00	\$4,000.00
47	10' BOTTOM OVERFLOW SWALES, PER GRADING PLAN, AS DIRECTED BY THE ENGINEER, COMPLETE IN PLACE	SY	949	\$4.00	\$3,796.00	\$5.00	\$4,745.00	\$4.00	\$3,796.00
48	INSTALL AND MAINTAIN SOD WITH 6" GALVANIZED SOD STAPLES PLACED EVERY 3', INCLUDES REMOVAL OF STAPLES AT DIRECTION OF THE ENGINEER, COMPLETE IN PLACE	SY	1000	\$5.00	\$5,000.00	\$8.25	\$8,250.00	\$13.00	\$13,000.00
49	OVER EXCAVATION OF UNSUITABLE MATERIAL FOR FILL PLACEMENT, AS DIRECTED BY ENGINEER, COMPLETE IN PLACE	CY	4000	\$3.00	\$12,000.00	\$3.00	\$12,000.00	\$5.00	\$20,000.00
50	CEMENT STABILIZED SAND (TO BE USED ONLY AS DIRECTED BY THE ENGINEER), COMPLETE IN PLACE	CY	750	\$35.00	\$26,250.00	\$60.00	\$45,000.00	\$50.00	\$37,500.00
51	5' REINFORCED CONCRETE SIDEWALK, AS DIRECTED BY ENGINEER, COMPLETE IN PLACE	LF	2820	\$34.00	\$95,880.00	\$38.00	\$107,160.00	\$42.00	\$118,440.00
52	REMOVE AND REPLACE 5' REINFORCED CONCRETE SIDEWALK ALONG TAMARRON TRACE, AS NECESSARY, AS DIRECTED BY THE ENGINEER, COMPLETE IN PLACE	LF	500	\$40.00	\$20,000.00	\$55.00	\$27,500.00	\$60.00	\$30,000.00
53	REINSPECTION FEE, PER FORT BEND COUNTY REQUIREMENTS, AS NEEDED, COMPLETE IN PLACE	EA	1	\$500.00	\$500.00	\$500.00	\$500.00	\$500.00	\$500.00
54	REINSPECTION FEE DUE TO EXCEEDING 60-DAY TIME PERIOD, PER FORT BEND COUNTY REQUIREMENTS, AS NEEDED, COMPLETE IN PLACE	EA	1	\$1,000.00	\$1,000.00	\$1,000.00	\$1,000.00	\$1,000.00	\$1,000.00

BID TABULATION FOR:

BID OPENING DATE:
BID OPENING LOCATION:
TABULATION BY:
TABULATION DATE:
LJA JOB NO.

CONSTRUCTION OF PAVING AND APPURTENANCES
 TO SERVE TAMARRON SECTION 21
 FORT BEND COUNTY MUNICIPAL UTILITY DISTRICT NO. 182
 CITY OF FULSHEAR E.T.J., FORT BEND COUNTY, TEXAS
 SEPTEMBER 17, 2020
 LJA ENGINEERING, INC.
 D. FORREST
 SEPTEMBER 17, 2020
 1931-6021B (9.2)

ITEM	DESCRIPTION	UNIT	QTY	4) TRIPLE B SERVICES, LLP		5) HARRIS CONSTRUCTION COMPANY, LTD.		6) DACO PAVING, INC.	
				UNIT COST	TOTAL COST	UNIT COST	TOTAL COST	UNIT COST	TOTAL COST
55	METHOD "A" CONSTRUCTION STAKING BY THE CONTRACTOR PER GBI PARTNERS, LP, 281.499.4539, COMPLETE IN PLACE	LS	1	\$10,000.00	\$10,000.00	\$10,000.00	\$10,000.00	\$10,000.00	\$10,000.00
56	AS-BUILT FINAL LOT GRADING SURVEY BY THE CONTRACTOR, INCLUDING BERM, SWALES, AND ALL FILL AREAS, PER GBI PARTNERS, LP, 281.499.4539, COMPLETE IN PLACE	LS	1	\$3,000.00	\$3,000.00	\$3,000.00	\$3,000.00	\$3,000.00	\$3,000.00
57	CITY OF FULSHEAR INSPECTION FEE, 0.75% OF THE TOTAL CONSTRUCTION COST, COMPLETE IN PLACE	LS	1	\$11,800.00	\$11,800.00	\$15,250.00	\$15,250.00	\$12,550.00	\$12,550.00
58	ALLOWANCE FOR FORT BEND COUNTY PERMIT FOR WORK INSIDE RIGHT OF WAY, AS NECESSARY, COMPLETE IN PLACE	EA	3	\$500.00	\$1,500.00	\$500.00	\$1,500.00	\$500.00	\$1,500.00
PAVING AND APPURTENANCES ITEMS SUBTOTAL:					\$1,583,564.12	\$1,595,788.95		\$1,670,606.65	
<u>BIDDING SUMMARY</u>									
SUBTOTAL PAVING AND APPURTENANCES ITEMS					\$1,583,564.12	\$1,595,788.95		\$1,670,606.65	
TOTAL AMOUNT BASE BID					\$1,583,564.12	\$1,595,788.95		\$1,670,606.65	

