

BID TABULATION FOR:

CONSTRUCTION OF THE PAVING AND APPURTENANCES
TO SERVE MEADOWS SECTION 3 PHASE 3
RIVER RANCH IMPROVEMENT DISTRICT
CITY OF DAYTON E.T.J., LIBERTY COUNTY, TEXAS
MAY 5, 2023
LJA ENGINEERING, INC.
D. FORREST
MAY 5, 2023
2973-0313B (9.2)

BID OPENING DATE:
BID OPENING LOCATION:
TABULATION BY:
TABULATION DATE:
LJA JOB NO.

BIDDER'S NAME	TOTAL AMOUNT BID
1) PRINCIPAL SERVICES, LTD	\$1,155,391.80
2) BEYER CONSTRUCTION, LLC	\$1,158,882.55
3) PRECISE SERVICES INC.	\$1,178,590.00
4) R CONSTRUCTION CIVIL, LLC	\$1,188,325.75
5) DACO PAVING, INC.	\$1,196,187.80
6) ALLGOOD CONSTRUCTION CO., INC.	\$1,228,473.82
7) TRIPLE B SERVICES, LLP	\$1,236,265.30
8) HARRIS CONSTRUCTION COMPANY, LLC	\$1,262,200.55
9) HCG, LLC.	\$1,294,423.65

CALENDAR DAYS - 45/60



I, Nicholas Hollek, P.E., hereby certify these bid tabulations to be true and correct.

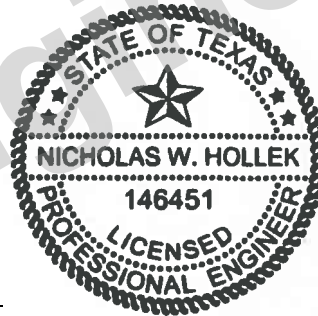

05/08/2023

BID TABULATION FOR:

BID OPENING DATE:
BID OPENING LOCATION:
TABULATION BY:
TABULATION DATE:
LJA JOB NO.

CONSTRUCTION OF THE PAVING AND APPURTENANCES
 TO SERVE MEADOWS SECTION 3 PHASE 3
 RIVER RANCH IMPROVEMENT DISTRICT
 CITY OF DAYTON E.T.J., LIBERTY COUNTY, TEXAS
 MAY 5, 2023
 LJA ENGINEERING, INC.
 D. FORREST
 MAY 5, 2023
 2973-0313B (9.2)

ITEM	DESCRIPTION	UNIT	QTY	1) PRINCIPAL SERVICES, LTD		2) BEYER CONSTRUCTION, LLC		3) PRECISE SERVICES INC.	
				UNIT COST	TOTAL COST	UNIT COST	TOTAL COST	UNIT COST	TOTAL COST
MEADOWS SECTION 3 PHASE 3 PAVING AND APPURTENANCES ITEMS									
1	6" REINFORCED CONCRETE PAVEMENT, COMPLETE IN PLACE	SY	15179	\$49.40	\$749,842.60	\$48.95	\$743,012.05	\$49.00	\$743,771.00
2	6" REINFORCED CONCRETE CURB, COMPLETE IN PLACE	LF	2539	\$3.00	\$7,617.00	\$4.35	\$11,044.65	\$4.85	\$12,314.15
3	4" X 12" REINFORCED CONCRETE CURB, COMPLETE IN PLACE	LF	6047	\$3.00	\$18,141.00	\$4.35	\$26,304.45	\$4.85	\$29,327.95
4	8" LIME STABILIZED SUBGRADE, INCLUDES COMPACTION TO 95% STANDARD PROCTOR DENSITY, COMPLETE IN PLACE	SY	17082	\$3.50	\$59,787.00	\$2.20	\$37,580.40	\$2.80	\$47,829.60
5	LIME FOR 8" STABILIZED SUBGRADE PREPARATION, 8% BY DRY WEIGHT (46 LBS/SY) AS REQUIRED BY SOIL CONDITIONS AND APPROVED BY GEOTECHNICAL ENGINEER, COMPLETE IN PLACE	TON	393	\$300.00	\$117,900.00	\$295.00	\$115,935.00	\$300.00	\$117,900.00
6	EXCAVATION TO BE USED FOR ONSITE FILL, INCLUDES EXCAVATION, HAULING, PLACING AND COMPACTION TO 95% STANDARD PROCTOR DENSITY WITH MAXIMUM 8" LIFTS, COMPLETE IN PLACE	CY	9300	\$5.40	\$50,220.00	\$5.85	\$54,405.00	\$4.85	\$45,105.00
7	FINAL LOT GRADING, INCLUDING RESERVES, STRIPPING AND PROOFROLLING, HAULING, PLACEMENT AND COMPACTION OF MATERIALS AND REPLACEMENT OF STRIPPINGS, COMPLETE IN PLACE	LS	1	\$12,500.00	\$12,500.00	\$18,200.00	\$18,200.00	\$18,000.00	\$18,000.00
8	TYPE 7, 8' WIDE, WHEELCHAIR RAMPS, INCLUDING TRUNCATED DOME SURFACE TO BE STAINED WITH CONTRASTING COLOR PER THE CONSTRUCTION PLAN SET, INCLUDES REMOVAL OF EXISTING CURB IF REQUIRED AND ALL OTHER APPURTENANCES, COMPLETE IN PLACE	EA	22	\$2,200.00	\$48,400.00	\$1,550.00	\$34,100.00	\$1,625.00	\$35,750.00
9	PERMANENT TRAFFIC CONTROL DEVICES, INCLUDING TRAFFIC BUTTONS, PAVEMENT STRIPING, MARKERS, REFLECTIVE PAINT ON MEDIAN NOSES, STOP SIGNS, STREET SIGNS, AND ALL OTHER TRAFFIC SIGNS SHOWN IN PLANS, ETC., COMPLETE IN PLACE	LS	1	\$6,500.00	\$6,500.00	\$10,160.00	\$10,160.00	\$11,500.00	\$11,500.00
10	REMOVE AND DISPOSE OF EXISTING TYPE III BARRICADE, COMPLETE IN PLACE	EA	3	\$91.00	\$273.00	\$5.00	\$15.00	\$100.00	\$300.00
11	INSTALL TYPE III BARRICADE, COMPLETE IN PLACE	EA	3	\$900.00	\$2,700.00	\$1,320.00	\$3,960.00	\$1,300.00	\$3,900.00
12	CONNECT PROPOSED 6" REINFORCED CONCRETE PAVEMENT TO EXISTING REINFORCED CONCRETE PAVEMENT, COMPLETE IN PLACE	LF	87	\$10.00	\$870.00	\$25.00	\$2,175.00	\$32.00	\$2,784.00
13	REINFORCED CONCRETE PAVING HEADER, COMPLETE IN PLACE	LF	87	\$10.00	\$870.00	\$20.00	\$1,740.00	\$20.00	\$1,740.00
14	4" SQUARE DOUBLE REFLECTORIZED BLUE TRAFFIC BUTTONS FOR FIRE HYDRANT LOCATION, COMPLETE IN PLACE	EA	10	\$10.00	\$100.00	\$7.20	\$72.00	\$17.00	\$170.00
15	6" SCHEDULE 40 IRRIGATION SLEEVES, COMPLETE IN PLACE	LF	140	\$35.00	\$4,900.00	\$32.00	\$4,480.00	\$45.00	\$6,300.00
16	1-1/2" TYPE "D" HMAC PAVING WITH 6" FLEXIBLE BASE AND PRIME COAT, COMPLETE IN PLACE	SY	632	\$64.00	\$40,448.00	\$68.00	\$42,976.00	\$68.50	\$43,292.00
MEADOWS SECTION 3 PHASE 3 PAVING AND APPURTENANCES ITEMS SUBTOTAL:					\$1,121,068.60		\$1,106,159.55		\$1,119,983.70
MEADOWS SECTION 3 PHASE 3 GENERAL ITEMS									
1	INLET PROTECTION BARRIERS, SWMHCA SPECIFICATION NO. 4511, (TO BE USED ONLY AS DIRECTED BY THE ENGINEER), COMPLETE IN PLACE	EA	41	\$50.00	\$2,050.00	\$25.00	\$1,025.00	\$65.00	\$2,665.00
2	INSTALLATION AND REMOVAL OF REINFORCED FILTER FABRIC FENCE, SWMHCA SPECIFICATION NO. 4311, (TO BE USED ONLY AS DIRECTED BY THE ENGINEER), COMPLETE IN PLACE	LF	10082	\$0.10	\$1,008.20	\$1.50	\$15,123.00	\$2.15	\$21,676.30
3	INSTALLATION AND REMOVAL OF CONCRETE WASHOUT AREA, COMPLETE IN PLACE	EA	1	\$500.00	\$500.00	\$1,920.00	\$1,920.00	\$2,000.00	\$2,000.00

BID TABULATION FOR:

BID OPENING DATE:
BID OPENING LOCATION:
TABULATION BY:
TABULATION DATE:
LJA JOB NO.

CONSTRUCTION OF THE PAVING AND APPURTENANCES
 TO SERVE MEADOWS SECTION 3 PHASE 3
 RIVER RANCH IMPROVEMENT DISTRICT
 CITY OF DAYTON E.T.J., LIBERTY COUNTY, TEXAS
 MAY 5, 2023
 LJA ENGINEERING, INC.
 D. FORREST
 MAY 5, 2023
 2973-0313B (9.2)

ITEM	DESCRIPTION	UNIT	QTY	1) PRINCIPAL SERVICES, LTD		2) BEYER CONSTRUCTION, LLC		3) PRECISE SERVICES INC.	
				UNIT COST	TOTAL COST	UNIT COST	TOTAL COST	UNIT COST	TOTAL COST
4	STORMWATER POLLUTION PREVENTION PLAN COMPLIANCE, INCLUDING CONTRACTOR'S BOOKLET NOI AND NOT, COMPLETE IN PLACE	LS	1	\$500.00	\$500.00	\$5,590.00	\$5,590.00	\$2,500.00	\$2,500.00
5	STABILIZED CONSTRUCTION EXIT (TO BE USED ONLY AS DIRECTED BY THE ENGINEER), INCLUDES CONSTRUCTION, MAINTENANCE AND REMOVAL, COMPLETE IN PLACE	EA	1	\$2,500.00	\$2,500.00	\$1,300.00	\$1,300.00	\$2,000.00	\$2,000.00
6	EXTRA CEMENT STABILIZED SAND (TO BE USED ONLY AS DIRECTED BY THE ENGINEER), COMPLETE IN PLACE	TON	317	\$45.00	\$14,265.00	\$45.00	\$14,265.00	\$45.00	\$14,265.00
7	FINAL LOT STAKING (INCLUDES 95 LOTS, 2 RESERVES, VERTICAL ELEVATIONS AT PINS ONLY) TO BE DONE BY LJA SURVEYING, CONTACT STEPHEN MATOVICH AT 936.777.6802 OR SMATOVICH@LJASURVEYING.COM, COMPLETE IN PLACE	LS	1	\$13,500.00	\$13,500.00	\$13,500.00	\$13,500.00	\$13,500.00	\$13,500.00
MEADOWS SECTION 3 PHASE 3 GENERAL ITEMS SUBTOTAL:					\$34,323.20	\$52,723.00	\$58,606.30		
<u>BIDDING SUMMARY</u>									
SUBTOTAL MEADOWS SECTION 3 PHASE 3 PAVING AND APPURTENANCES ITEMS					\$1,121,068.60	\$1,106,159.55	\$1,119,983.70		
SUBTOTAL MEADOWS SECTION 3 PHASE 3 GENERAL ITEMS					\$34,323.20	\$52,723.00	\$58,606.30		
TOTAL AMOUNT BASE BID					\$1,155,391.80	\$1,158,882.55	\$1,178,590.00		

LJA Engineering, Inc.

BID TABULATION FOR:

CONSTRUCTION OF THE PAVING AND APPURTENANCES
 TO SERVE MEADOWS SECTION 3 PHASE 3
 RIVER RANCH IMPROVEMENT DISTRICT
 CITY OF DAYTON E.T.J., LIBERTY COUNTY, TEXAS
 MAY 5, 2023
 LJA ENGINEERING, INC.
 D. FORREST
 MAY 5, 2023
 2973-0313B (9.2)

BID OPENING DATE:
BID OPENING LOCATION:
TABULATION BY:
TABULATION DATE:
LJA JOB NO.

ITEM	DESCRIPTION	UNIT	QTY	4) R CONSTRUCTION CIVIL, LLC		5) DACO PAVING, INC.		6) ALLGOOD CONSTRUCTION CO., INC.	
				UNIT COST	TOTAL COST	UNIT COST	TOTAL COST	UNIT COST	TOTAL COST
MEADOWS SECTION 3 PHASE 3 PAVING AND APPURTENANCES ITEMS									
1	6" REINFORCED CONCRETE PAVEMENT, COMPLETE IN PLACE	SY	15179	\$51.25	\$777,923.75	\$47.50	\$721,002.50	\$52.65	\$799,174.35
2	6" REINFORCED CONCRETE CURB, COMPLETE IN PLACE	LF	2539	\$4.00	\$10,156.00	\$4.00	\$10,156.00	\$4.68	\$11,882.52
3	4" X 12" REINFORCED CONCRETE CURB, COMPLETE IN PLACE	LF	6047	\$4.00	\$24,188.00	\$4.00	\$24,188.00	\$4.68	\$28,299.96
4	8" LIME STABILIZED SUBGRADE, INCLUDES COMPACTION TO 95% STANDARD PROCTOR DENSITY, COMPLETE IN PLACE	SY	17082	\$3.50	\$59,787.00	\$4.00	\$68,328.00	\$3.51	\$59,957.82
5	LIME FOR 8" STABILIZED SUBGRADE PREPARATION, 8% BY DRY WEIGHT (46 LBS/SY) AS REQUIRED BY SOIL CONDITIONS AND APPROVED BY GEOTECHNICAL ENGINEER, COMPLETE IN PLACE	TON	393	\$300.00	\$117,900.00	\$310.00	\$121,830.00	\$343.98	\$135,184.14
6	EXCAVATION TO BE USED FOR ONSITE FILL, INCLUDES EXCAVATION, HAULING, PLACING AND COMPACTION TO 95% STANDARD PROCTOR DENSITY WITH MAXIMUM 8" LIFTS, COMPLETE IN PLACE	CY	9300	\$4.00	\$37,200.00	\$6.50	\$60,450.00	\$3.80	\$35,340.00
7	FINAL LOT GRADING, INCLUDING RESERVES, STRIPPING AND PROOFROLLING, HAULING, PLACEMENT AND COMPACTION OF MATERIALS AND REPLACEMENT OF STRIPPINGS, COMPLETE IN PLACE	LS	1	\$20,000.00	\$20,000.00	\$18,000.00	\$18,000.00	\$20,826.00	\$20,826.00
8	TYPE 7, 8' WIDE, WHEELCHAIR RAMPS, INCLUDING TRUNCATED DOME SURFACE TO BE STAINED WITH CONTRASTING COLOR PER THE CONSTRUCTION PLAN SET, INCLUDES REMOVAL OF EXISTING CURB IF REQUIRED AND ALL OTHER APPURTENANCES, COMPLETE IN PLACE	EA	22	\$1,700.00	\$37,400.00	\$2,600.00	\$57,200.00	\$1,462.50	\$32,175.00
9	PERMANENT TRAFFIC CONTROL DEVICES, INCLUDING TRAFFIC BUTTONS, PAVEMENT STRIPING, MARKERS, REFLECTIVE PAINT ON MEDIAN NOSES, STOP SIGNS, STREET SIGNS, AND ALL OTHER TRAFFIC SIGNS SHOWN IN PLANS, ETC., COMPLETE IN PLACE	LS	1	\$10,500.00	\$10,500.00	\$11,800.00	\$11,800.00	\$5,967.00	\$5,967.00
10	REMOVE AND DISPOSE OF EXISTING TYPE III BARRICADE, COMPLETE IN PLACE	EA	3	\$1.00	\$3.00	\$1.00	\$3.00	\$117.00	\$351.00
11	INSTALL TYPE III BARRICADE, COMPLETE IN PLACE	EA	3	\$1,175.00	\$3,525.00	\$1,300.00	\$3,900.00	\$1,170.00	\$3,510.00
12	CONNECT PROPOSED 6" REINFORCED CONCRETE PAVEMENT TO EXISTING REINFORCED CONCRETE PAVEMENT, COMPLETE IN PLACE	LF	87	\$40.00	\$3,480.00	\$15.00	\$1,305.00	\$11.70	\$1,017.90
13	REINFORCED CONCRETE PAVING HEADER, COMPLETE IN PLACE	LF	87	\$25.00	\$2,175.00	\$15.00	\$1,305.00	\$11.70	\$1,017.90
14	4" SQUARE DOUBLE REFLECTORIZED BLUE TRAFFIC BUTTONS FOR FIRE HYDRANT LOCATION, COMPLETE IN PLACE	EA	10	\$15.00	\$150.00	\$17.00	\$170.00	\$17.55	\$175.50
15	6" SCHEDULE 40 IRRIGATION SLEEVES, COMPLETE IN PLACE	LF	140	\$35.00	\$4,900.00	\$55.00	\$7,700.00	\$29.25	\$4,095.00
16	1-1/2" TYPE "D" HMAC PAVING WITH 6" FLEXIBLE BASE AND PRIME COAT, COMPLETE IN PLACE	SY	632	\$50.00	\$31,600.00	\$46.00	\$29,072.00	\$67.68	\$42,773.76
MEADOWS SECTION 3 PHASE 3 PAVING AND APPURTENANCES ITEMS SUBTOTAL:					\$1,140,887.75		\$1,136,409.50		\$1,181,747.85
MEADOWS SECTION 3 PHASE 3 GENERAL ITEMS									
1	INLET PROTECTION BARRIERS, SWMHCA SPECIFICATION NO. 4511, (TO BE USED ONLY AS DIRECTED BY THE ENGINEER), COMPLETE IN PLACE	EA	41	\$50.00	\$2,050.00	\$157.00	\$6,437.00	\$29.25	\$1,199.25
2	INSTALLATION AND REMOVAL OF REINFORCED FILTER FABRIC FENCE, SWMHCA SPECIFICATION NO. 4311, (TO BE USED ONLY AS DIRECTED BY THE ENGINEER), COMPLETE IN PLACE	LF	10082	\$1.50	\$15,123.00	\$2.15	\$21,676.30	\$1.46	\$14,719.72
3	INSTALLATION AND REMOVAL OF CONCRETE WASHOUT AREA, COMPLETE IN PLACE	EA	1	\$500.00	\$500.00	\$500.00	\$500.00	\$936.00	\$936.00

BID TABULATION FOR:

CONSTRUCTION OF THE PAVING AND APPURTENANCES
 TO SERVE MEADOWS SECTION 3 PHASE 3
 RIVER RANCH IMPROVEMENT DISTRICT
 CITY OF DAYTON E.T.J., LIBERTY COUNTY, TEXAS
 MAY 5, 2023
 LJA ENGINEERING, INC.
 D. FORREST
 MAY 5, 2023
 2973-0313B (9.2)

BID OPENING DATE:
BID OPENING LOCATION:
TABULATION BY:
TABULATION DATE:
LJA JOB NO.

ITEM	DESCRIPTION	UNIT	QTY	4) R CONSTRUCTION CIVIL, LLC		5) DACO PAVING, INC.		6) ALLGOOD CONSTRUCTION CO., INC.	
				UNIT COST	TOTAL COST	UNIT COST	TOTAL COST	UNIT COST	TOTAL COST
4	STORMWATER POLLUTION PREVENTION PLAN COMPLIANCE, INCLUDING CONTRACTOR'S BOOKLET NOI AND NOT, COMPLETE IN PLACE	LS	1	\$1,000.00	\$1,000.00	\$2,000.00	\$2,000.00	\$643.50	\$643.50
5	STABILIZED CONSTRUCTION EXIT (TO BE USED ONLY AS DIRECTED BY THE ENGINEER), INCLUDES CONSTRUCTION, MAINTENANCE AND REMOVAL, COMPLETE IN PLACE	EA	1	\$1,000.00	\$1,000.00	\$1,400.00	\$1,400.00	\$1,462.50	\$1,462.50
6	EXTRA CEMENT STABILIZED SAND (TO BE USED ONLY AS DIRECTED BY THE ENGINEER), COMPLETE IN PLACE	TON	317	\$45.00	\$14,265.00	\$45.00	\$14,265.00	\$45.00	\$14,265.00
7	FINAL LOT STAKING (INCLUDES 95 LOTS, 2 RESERVES, VERTICAL ELEVATIONS AT PINS ONLY) TO BE DONE BY LJA SURVEYING, CONTACT STEPHEN MATOVICH AT 936.777.6802 OR SMATOVICH@LJASURVEYING.COM, COMPLETE IN PLACE	LS	1	\$13,500.00	\$13,500.00	\$13,500.00	\$13,500.00	\$13,500.00	\$13,500.00
MEADOWS SECTION 3 PHASE 3 GENERAL ITEMS SUBTOTAL:					\$47,438.00	\$59,778.30	\$46,725.97		
<u>BIDDING SUMMARY</u>									
SUBTOTAL MEADOWS SECTION 3 PHASE 3 PAVING AND APPURTENANCES ITEMS					\$1,140,887.75	\$1,136,409.50	\$1,181,747.85		
SUBTOTAL MEADOWS SECTION 3 PHASE 3 GENERAL ITEMS					\$47,438.00	\$59,778.30	\$46,725.97		
TOTAL AMOUNT BASE BID					\$1,188,325.75	\$1,196,187.80	\$1,228,473.82		

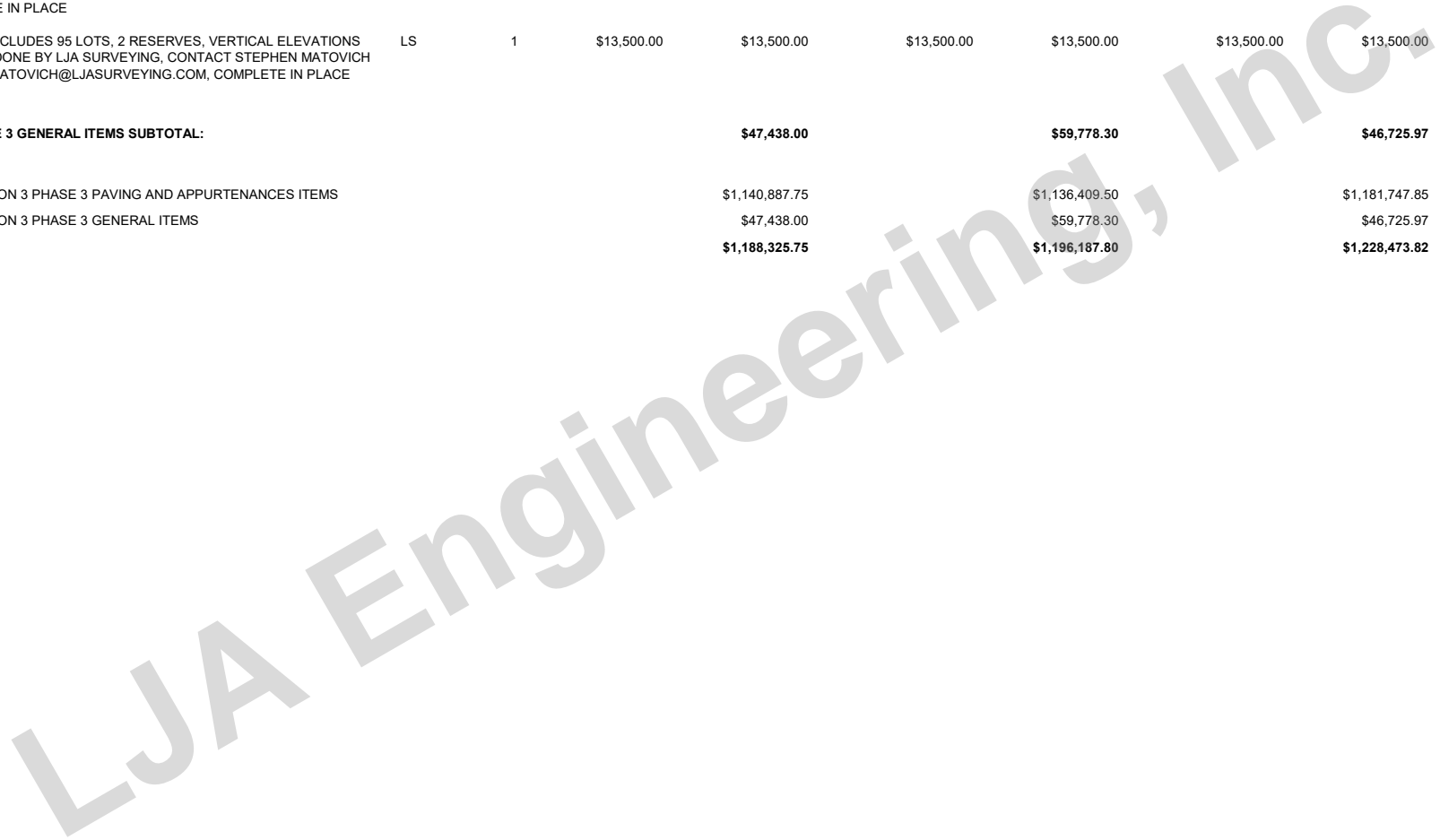

BID TABULATION FOR:

CONSTRUCTION OF THE PAVING AND APPURTENANCES
 TO SERVE MEADOWS SECTION 3 PHASE 3
 RIVER RANCH IMPROVEMENT DISTRICT
 CITY OF DAYTON E.T.J., LIBERTY COUNTY, TEXAS
 MAY 5, 2023
 LJA ENGINEERING, INC.
 D. FORREST
 MAY 5, 2023
 2973-0313B (9.2)

BID OPENING DATE:
BID OPENING LOCATION:
TABULATION BY:
TABULATION DATE:
LJA JOB NO.

ITEM	DESCRIPTION	UNIT	QTY	7) TRIPLE B SERVICES, LLP		8) HARRIS CONSTRUCTION COMPANY, LLC		9) HCG, LLC.	
				UNIT COST	TOTAL COST	UNIT COST	TOTAL COST	UNIT COST	TOTAL COST
MEADOWS SECTION 3 PHASE 3 PAVING AND APPURTENANCES ITEMS									
1	6" REINFORCED CONCRETE PAVEMENT, COMPLETE IN PLACE	SY	15179	\$48.90	\$742,253.10	\$53.55	\$812,835.45	\$50.10	\$760,467.90
2	6" REINFORCED CONCRETE CURB, COMPLETE IN PLACE	LF	2539	\$4.25	\$10,790.75	\$3.85	\$9,775.15	\$4.10	\$10,409.90
3	4" X 12" REINFORCED CONCRETE CURB, COMPLETE IN PLACE	LF	6047	\$4.25	\$25,699.75	\$3.85	\$23,280.95	\$4.10	\$24,792.70
4	8" LIME STABILIZED SUBGRADE, INCLUDES COMPACTION TO 95% STANDARD PROCTOR DENSITY, COMPLETE IN PLACE	SY	17082	\$4.70	\$80,285.40	\$2.15	\$36,726.30	\$4.85	\$82,847.70
5	LIME FOR 8" STABILIZED SUBGRADE PREPARATION, 8% BY DRY WEIGHT (46 LBS/SY) AS REQUIRED BY SOIL CONDITIONS AND APPROVED BY GEOTECHNICAL ENGINEER, COMPLETE IN PLACE	TON	393	\$330.00	\$129,690.00	\$375.00	\$147,375.00	\$329.00	\$129,297.00
6	EXCAVATION TO BE USED FOR ONSITE FILL, INCLUDES EXCAVATION, HAULING, PLACING AND COMPACTION TO 95% STANDARD PROCTOR DENSITY WITH MAXIMUM 8" LIFTS, COMPLETE IN PLACE	CY	9300	\$5.75	\$53,475.00	\$4.00	\$37,200.00	\$4.35	\$40,455.00
7	FINAL LOT GRADING, INCLUDING RESERVES, STRIPPING AND PROOFROLLING, HAULING, PLACEMENT AND COMPACTION OF MATERIALS AND REPLACEMENT OF STRIPPINGS, COMPLETE IN PLACE	LS	1	\$25,900.00	\$25,900.00	\$20,855.00	\$20,855.00	\$34,750.00	\$34,750.00
8	TYPE 7, 8' WIDE, WHEELCHAIR RAMPS, INCLUDING TRUNCATED DOME SURFACE TO BE STAINED WITH CONTRASTING COLOR PER THE CONSTRUCTION PLAN SET, INCLUDES REMOVAL OF EXISTING CURB IF REQUIRED AND ALL OTHER APPURTENANCES, COMPLETE IN PLACE	EA	22	\$2,630.00	\$57,860.00	\$2,150.00	\$47,300.00	\$2,055.00	\$45,210.00
9	PERMANENT TRAFFIC CONTROL DEVICES, INCLUDING TRAFFIC BUTTONS, PAVEMENT STRIPING, MARKERS, REFLECTIVE PAINT ON MEDIAN NOSES, STOP SIGNS, STREET SIGNS, AND ALL OTHER TRAFFIC SIGNS SHOWN IN PLANS, ETC., COMPLETE IN PLACE	LS	1	\$11,970.00	\$11,970.00	\$7,995.00	\$7,995.00	\$12,000.00	\$12,000.00
10	REMOVE AND DISPOSE OF EXISTING TYPE III BARRICADE, COMPLETE IN PLACE	EA	3	\$178.00	\$534.00	\$200.00	\$600.00	\$193.00	\$579.00
11	INSTALL TYPE III BARRICADE, COMPLETE IN PLACE	EA	3	\$1,360.00	\$4,080.00	\$1,425.00	\$4,275.00	\$1,360.00	\$4,080.00
12	CONNECT PROPOSED 6" REINFORCED CONCRETE PAVEMENT TO EXISTING REINFORCED CONCRETE PAVEMENT, COMPLETE IN PLACE	LF	87	\$14.50	\$1,261.50	\$12.00	\$1,044.00	\$23.35	\$2,031.45
13	REINFORCED CONCRETE PAVING HEADER, COMPLETE IN PLACE	LF	87	\$16.50	\$1,435.50	\$10.00	\$870.00	\$19.30	\$1,679.10
14	4" SQUARE DOUBLE REFLECTORIZED BLUE TRAFFIC BUTTONS FOR FIRE HYDRANT LOCATION, COMPLETE IN PLACE	EA	10	\$17.00	\$170.00	\$11.00	\$110.00	\$17.35	\$173.50
15	6" SCHEDULE 40 IRRIGATION SLEEVES, COMPLETE IN PLACE	LF	140	\$42.00	\$5,880.00	\$50.00	\$7,000.00	\$55.15	\$7,721.00
16	1-1/2" TYPE "D" HMAC PAVING WITH 6" FLEXIBLE BASE AND PRIME COAT, COMPLETE IN PLACE	SY	632	\$24.00	\$15,168.00	\$67.50	\$42,660.00	\$101.65	\$64,242.80
MEADOWS SECTION 3 PHASE 3 PAVING AND APPURTENANCES ITEMS SUBTOTAL:					\$1,166,453.00		\$1,199,901.85		\$1,220,737.05
MEADOWS SECTION 3 PHASE 3 GENERAL ITEMS									
1	INLET PROTECTION BARRIERS, SWMHCA SPECIFICATION NO. 4511, (TO BE USED ONLY AS DIRECTED BY THE ENGINEER), COMPLETE IN PLACE	EA	41	\$69.00	\$2,829.00	\$50.00	\$2,050.00	\$115.70	\$4,743.70
2	INSTALLATION AND REMOVAL OF REINFORCED FILTER FABRIC FENCE, SWMHCA SPECIFICATION NO. 4311, (TO BE USED ONLY AS DIRECTED BY THE ENGINEER), COMPLETE IN PLACE	LF	10082	\$3.15	\$31,758.30	\$2.85	\$28,733.70	\$3.45	\$34,782.90
3	INSTALLATION AND REMOVAL OF CONCRETE WASHOUT AREA, COMPLETE IN PLACE	EA	1	\$1,040.00	\$1,040.00	\$1,000.00	\$1,000.00	\$2,890.00	\$2,890.00

BID TABULATION FOR:

CONSTRUCTION OF THE PAVING AND APPURTENANCES
TO SERVE MEADOWS SECTION 3 PHASE 3
RIVER RANCH IMPROVEMENT DISTRICT
CITY OF DAYTON E.T.J., LIBERTY COUNTY, TEXAS
MAY 5, 2023
LJA ENGINEERING, INC.
D. FORREST
MAY 5, 2023
2973-0313B (9.2)

BID OPENING DATE:
BID OPENING LOCATION:
TABULATION BY:
TABULATION DATE:
LJA JOB NO.

ITEM	DESCRIPTION	UNIT	QTY	7) TRIPLE B SERVICES, LLP		8) HARRIS CONSTRUCTION COMPANY, LLC		9) HCG, LLC.	
				UNIT COST	TOTAL COST	UNIT COST	TOTAL COST	UNIT COST	TOTAL COST
4	STORMWATER POLLUTION PREVENTION PLAN COMPLIANCE, INCLUDING CONTRACTOR'S BOOKLET NOI AND NOT, COMPLETE IN PLACE	LS	1	\$2,740.00	\$2,740.00	\$750.00	\$750.00	\$1,445.00	\$1,445.00
5	STABILIZED CONSTRUCTION EXIT (TO BE USED ONLY AS DIRECTED BY THE ENGINEER), INCLUDES CONSTRUCTION, MAINTENANCE AND REMOVAL, COMPLETE IN PLACE	EA	1	\$3,680.00	\$3,680.00	\$2,000.00	\$2,000.00	\$2,060.00	\$2,060.00
6	EXTRA CEMENT STABILIZED SAND (TO BE USED ONLY AS DIRECTED BY THE ENGINEER), COMPLETE IN PLACE	TON	317	\$45.00	\$14,265.00	\$45.00	\$14,265.00	\$45.00	\$14,265.00
7	FINAL LOT STAKING (INCLUDES 95 LOTS, 2 RESERVES, VERTICAL ELEVATIONS AT PINS ONLY) TO BE DONE BY LJA SURVEYING, CONTACT STEPHEN MATOVICH AT 936.777.6802 OR SMATOVICH@LJASURVEYING.COM, COMPLETE IN PLACE	LS	1	\$13,500.00	\$13,500.00	\$13,500.00	\$13,500.00	\$13,500.00	\$13,500.00
MEADOWS SECTION 3 PHASE 3 GENERAL ITEMS SUBTOTAL:					\$69,812.30	\$62,298.70	\$73,686.60		
<u>BIDDING SUMMARY</u>									
SUBTOTAL MEADOWS SECTION 3 PHASE 3 PAVING AND APPURTENANCES ITEMS					\$1,166,453.00	\$1,199,901.85	\$1,220,737.05		
SUBTOTAL MEADOWS SECTION 3 PHASE 3 GENERAL ITEMS					\$69,812.30	\$62,298.70	\$73,686.60		
TOTAL AMOUNT BASE BID					\$1,236,265.30	\$1,262,200.55	\$1,294,423.65		

LJA Engineering, Inc.