

**BID TABULATION FOR:**

**BID OPENING DATE:**  
**BID OPENING LOCATION:**  
**TABULATION BY:**  
**TABULATION DATE:**  
**LJA JOB NO.**

CONSTRUCTION OF THE WATER, SANITARY SEWER, AND DRAINAGE FACILITIES  
TO SERVE TAVOLA SECTION 27  
EAST MONTGOMERY COUNTY MUNICIPAL UTILITY DISTRICT NO. 6  
MONTGOMERY, COUNTY, TEXAS  
FEBRUARY 11, 2020  
LJA ENGINEERING, INC.  
E. MURPHY  
FEBRUARY 12, 2020  
6966-1227 (9.2)

BIDDER'S NAME	TOTAL BID AMOUNT
1) CROSTEX CONSTRUCTION, INC.	\$667,000.00
2) C.E. BARKER, LTD.	\$684,765.88
3) BLAZEY CONSTRUCTION SERVICES, LLC	\$693,707.30
4) PRINCIPAL SERVICES, LTD.	\$724,000.00
5) TEXASITE, LLC	\$754,750.68
6) R CONSTRUCTION CIVIL, LLC DBA R CONSTRUCTION COMPANY	\$765,762.30
7) PRECISE SERVICES, INC.	\$922,503.80

CALENDAR DAYS - 30/40

LJA Engineering, Inc.

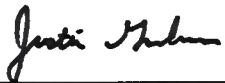

I, Justin Graham, PE, hereby certify these bid tabulations to be true and correct.

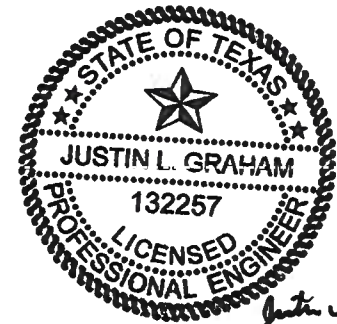

*Justin Graham*  
2/12/2020

**BID TABULATION FOR:**

**BID OPENING DATE:**  
**BID OPENING LOCATION:**  
**TABULATION BY:**  
**TABULATION DATE:**  
**LJA JOB NO.**

CONSTRUCTION OF THE WATER, SANITARY SEWER, AND DRAINAGE FACILITIES  
 TO SERVE TAVOLA SECTION 27  
 EAST MONTGOMERY COUNTY MUNICIPAL UTILITY DISTRICT NO. 6  
 MONTGOMERY, COUNTY, TEXAS  
 FEBRUARY 11, 2020  
 LJA ENGINEERING, INC.  
 E. MURPHY  
 FEBRUARY 12, 2020  
 6966-1227 (9.2)

ITEM DESCRIPTION	UNIT	QTY	1) CROSTEX CONSTRUCTION, INC.		2) C.E. BARKER, LTD.		3) BLAZEY CONSTRUCTION SERVICES, LLC		
			UNIT COST	TOTAL COST	UNIT COST	TOTAL COST	UNIT COST	TOTAL COST	
<b>WATER ITEMS</b>									
1. 8" P.V.C. WATER PIPE, C-900, DR 18, CLASS 235, ALL DEPTHS, COMPLETE IN PLACE	LF	1,743	\$15.65	\$27,277.95	\$13.04	\$22,728.72	\$12.13	\$21,142.59	
2. 12" P.V.C WATER PIPE, C-900, DR 18, CLASS 235, ALL DEPTHS, COMPLETE IN PLACE	LF	30	\$24.00	\$720.00	\$21.94	\$658.20	\$19.85	\$595.50	
3. FIRE HYDRANT UNIT, ALL DEPTHS, INCLUDES APPROPRIATE TEE, 6" GATE VALVE & BOX, 6" LEAD AND FIRE HYDRANT, COMPLETE IN PLACE	EA	7	\$2,900.00	\$20,300.00	\$3,473.15	\$24,312.05	\$3,233.93	\$22,637.51	
4. 8" AWWA GATE VALVE AND BOX, COMPLETE IN PLACE	EA	8	\$850.00	\$6,800.00	\$893.17	\$7,145.36	\$870.67	\$6,965.36	
5. DUCTILE IRON FITTINGS, COMPLETE IN PLACE	TON	0.93	\$2,500.00	\$2,325.00	\$2,205.90	\$2,051.49	\$1,720.92	\$1,600.46	
6. 4" P.V.C. WATER PIPE, C-900, DR 18, CLASS 235, RESTRAINED JOINT, ALL DEPTHS, COMPLETE IN PLACE	LF	76	\$15.00	\$1,140.00	\$13.19	\$1,002.44	\$13.56	\$1,030.56	
7. 6" P.V.C. WATER PIPE, C-900, DR 18, CLASS 235, RESTRAINED JOINT, ALL DEPTHS, COMPLETE IN PLACE	LF	287	\$18.00	\$5,166.00	\$15.11	\$4,336.57	\$15.73	\$4,514.51	
8. 8" P.V.C. WATER PIPE, C-900, DR-18, CLASS 235, RESTRAINED JOINT, ALL DEPTHS, COMPLETE IN PLACE	LF	245	\$25.00	\$6,125.00	\$20.66	\$5,061.70	\$21.46	\$5,257.70	
9. TRENCH SAFETY SYSTEM, ALL DEPTHS, COMPLETE IN PLACE	LF	2,381	\$0.05	\$119.05	\$0.11	\$261.91	\$0.27	\$642.87	
10. 8" PLUG AND CLAMP, COMPLETE IN PLACE	EA	3	\$105.00	\$315.00	\$286.39	\$859.17	\$196.95	\$590.85	
11. 2" BLOW-OFF VALVE & BOX ASSEMBLY, COMPLETE IN PLACE	EA	4	\$605.00	\$2,420.00	\$264.03	\$1,056.12	\$276.69	\$1,106.76	
12. 4" PLUG AND CLAMP, COMPLETE IN PLACE	EA	1	\$100.00	\$100.00	\$231.45	\$231.45	\$152.50	\$152.50	
13. REMOVE 12" PLUG AND CLAMP AND 2" BLOW OFF VALVE AND BOX AND CONNECT PROPOSED 12" WATER LINE INCLUDES ALL NECESSARY ADAPTERS, AND CONNECTORS (WET CONNECT), COMPLETE IN PLACE	EA	1	\$100.00	\$100.00	\$536.27	\$536.27	\$282.69	\$282.69	
14. 14" STEEL CASING FOR 8" WATER LINE, (EXCLUDES PVC CARRIER PIPE), COMPLETE IN PLACE	LF	20	\$100.00	\$2,000.00	\$78.69	\$1,573.80	\$60.00	\$1,200.00	
<b>SUBTOTAL WATER ITEMS</b>				<b>\$74,908.00</b>		<b>\$71,815.25</b>		<b>\$67,719.86</b>	
<b>SANITARY SEWER ITEMS</b>									
1. 8" P.V.C. GREEN SEWER PIPE, ASTM D-2241, SDR 26, 0'-8' CUT, COMPLETE IN PLACE	LF	1,570	\$22.50	\$35,325.00	\$21.18	\$33,252.60	\$26.80	\$42,076.00	
2. 8" P.V.C. GREEN SEWER PIPE, ASTM D-2241. SDR 26, 8' - 12' CUT. COMPLETE IN PLACE	LF	158	\$24.55	\$3,878.90	\$22.15	\$3,499.70	\$27.13	\$4,286.54	
3. EXTRA DEPTH OF SANITARY MANHOLE, (OVER 8' DEPTH), COMPLETE IN PLACE	VF	0.48	\$220.00	\$105.60	\$144.38	\$69.30	\$113.30	\$54.38	
4. STANDARD SANITARY SEWER MANHOLE FOR 6"-24" SANITARY SEWER PIPES, (0' - 8' DEPTH), INCLUDES INFLOW PROTECTOR, COMPLETE IN PLACE	EA	12	\$2,200.00	\$26,400.00	\$1,858.57	\$22,302.84	\$2,179.74	\$26,156.88	
5. "LONG SIDE" DOUBLE OR SINGLE 6" PVC PIPE SERVICE LEADS, ASTM D-2241, SDR 26, CLASS 160, ALL DEPTHS, INCLUDING DROP STRUCTURE, CEMENT STABILIZED SAND BACKFILL, STACK, RISER, WYE, PLUG, MARKER, AND ANY NECESSARY FITTINGS, ETC., COMPLETE IN PLACE	LF	881	\$29.75	\$26,209.75	\$30.53	\$26,896.93	\$27.73	\$24,430.13	

**BID TABULATION FOR:**

**BID OPENING DATE:**  
**BID OPENING LOCATION:**  
**TABULATION BY:**  
**TABULATION DATE:**  
**LJA JOB NO.**

CONSTRUCTION OF THE WATER, SANITARY SEWER, AND DRAINAGE FACILITIES  
 TO SERVE TAVOLA SECTION 27  
 EAST MONTGOMERY COUNTY MUNICIPAL UTILITY DISTRICT NO. 6  
 MONTGOMERY, COUNTY, TEXAS  
 FEBRUARY 11, 2020  
 LJA ENGINEERING, INC.  
 E. MURPHY  
 FEBRUARY 12, 2020  
 6966-1227 (9.2)

ITEM	DESCRIPTION	UNIT	QTY	1) CROSTEX CONSTRUCTION, INC.		2) C.E. BARKER, LTD.		3) BLAZEY CONSTRUCTION SERVICES, LLC	
				UNIT COST	TOTAL COST	UNIT COST	TOTAL COST	UNIT COST	TOTAL COST
6.	"SHORT SIDE" DOUBLE OR SINGLE 6" PVC PIPE SERVICE LEADS, ASTM D-2241, SDR 26, CLASS 160, ALL DEPTHS, INCLUDING CEMENT STABILIZED SAND BACKFILL, RISER, WYE, PLUG, DROP STRUCTURE, MARKER, AND ANY NECESSARY FITTINGS, ETC., COMPLETE IN PLACE	EA	15	\$1,007.00	\$15,105.00	\$601.19	\$9,017.85	\$1,121.51	\$16,822.65
7.	T.V. INSPECTION OF SANITARY SEWER LINES, (TO BE USED ONLY AT THE WRITTEN DIRECTION OF THE ENGINEER), COMPLETE IN PLACE	LF	1,728	\$0.01	\$17.28	\$0.11	\$190.08	\$2.32	\$4,008.96
8.	TRENCH SAFETY SYSTEM, ALL DEPTHS, COMPLETE IN PLACE	LF	2,609	\$0.05	\$130.45	\$0.11	\$286.99	\$0.27	\$704.43
9.	DEWATERING FOR SANITARY SEWER, ALL SIZES, ALL DEPTHS, (TO BE USED ONLY AS DIRECTED BY THE ENGINEER), COMPLETE IN PLACE	LF	500	\$20.00	\$10,000.00	\$20.00	\$10,000.00	\$20.00	\$10,000.00
10.	ADDITIONAL COST FOR MODIFIED "A-A" BEDDING FOR WET SAND CONSTRUCTION, ALL DEPTHS, ALL SIZES, (TO BE USED ONLY AS DIRECTED BY THE ENGINEER), COMPLETE IN PLACE	LF	500	\$12.00	\$6,000.00	\$12.00	\$6,000.00	\$12.00	\$6,000.00
11.	CORE INTO EXISTING SANITARY SEWER MANHOLE AND CONNECT PROPOSED 8" SANITARY SEWER, INCLUDES ALL NECESSARY CONNECTORS, ADAPTERS AND FITTINGS, COMPLETE IN PLACE	EA	3	\$1,750.00	\$5,250.00	\$942.96	\$2,828.88	\$1,079.08	\$3,237.24
12.	ADJUST EXISTING SANITARY MANHOLE TO 6" ABOVE TOP OF CURB, COMPLETE IN PLACE	EA	3	\$150.00	\$450.00	\$566.53	\$1,699.59	\$25.00	\$75.00
13.	REMOVE AND DISPOSE OF 8" SANITARY SEWER, COMPLETE IN PLACE	LF	26	\$20.00	\$520.00	\$26.36	\$685.36	\$26.98	\$701.48
14.	8" SANITARY SEWER PLUG, COMPLETE IN PLACE	EA	1	\$50.00	\$50.00	\$170.88	\$170.88	\$73.00	\$73.00
<b>SUBTOTAL SANITARY SEWER ITEMS</b>					<b>\$129,441.98</b>		<b>\$116,901.00</b>		<b>\$138,626.69</b>
<b>DRAINAGE FACILITIES ITEMS</b>									
1.	24" R.C.P. STORM SEWER, ASTM C-76, CLASS III, ALL DEPTHS, COMPLETE IN PLACE	LF	741	\$53.65	\$39,754.65	\$60.34	\$44,711.94	\$56.77	\$42,066.57
2.	30" R.C.P. STORM SEWER, ASTM C-76, CLASS III, ALL DEPTHS, COMPLETE IN PLACE	LF	457	\$66.40	\$30,344.80	\$76.11	\$34,782.27	\$73.14	\$33,424.98
3.	36" R.C.P. STORM SEWER, ASTM C-76, CLASS III, ALL DEPTHS, COMPLETE IN PLACE	LF	611	\$89.95	\$54,959.45	\$104.93	\$64,112.23	\$95.73	\$58,491.03
4.	48" R.C.P. STORM SEWER, ASTM C-76, CLASS III, ALL DEPTHS, COMPLETE IN PLACE	LF	317	\$143.35	\$45,441.95	\$164.44	\$52,127.48	\$153.22	\$48,570.74
5.	54" R.C.P. STORM SEWER, ASTM C-76, CLASS III, ALL DEPTHS, COMPLETE IN PLACE	LF	299	\$200.00	\$59,800.00	\$229.11	\$68,503.89	\$207.31	\$61,985.69
6.	60" R.C.P. STORM SEWER, ASTM C-76, CLASS III, ALL DEPTHS, COMPLETE IN PLACE	LF	348	\$230.00	\$80,040.00	\$276.77	\$96,315.96	\$236.14	\$82,176.72
7.	STAGE I - STANDARD 5' PRECAST INLET ("B-B"), (INCLUDES TEMPORARY SAND FILLED BURLAP BAGS FOR EROSION AND SEDIMENT CONTROL), COMPLETE IN PLACE	EA	10	\$1,800.00	\$18,000.00	\$1,030.71	\$10,307.10	\$1,143.82	\$11,438.20
8.	STAGE II - STANDARD 5' PRECAST INLET ("B-B"), (INCLUDES TEMPORARY SAND-FILLED BURLAP BAGS FOR EROSION AND SEDIMENT CONTROL), COMPLETE IN PLACE	EA	10	\$300.00	\$3,000.00	\$921.06	\$9,210.60	\$1,217.67	\$12,176.70
9.	STAGE 1- TYPE C-2 REINFORCED CONCRETE PRECAST CURB INLET, ALL DEPTHS, INCLUDES INLET PROTECTION BARRIER FOR STAGE 1 INLETS, COMPLETE IN PLACE	EA	3	\$2,300.00	\$6,900.00	\$1,359.66	\$4,078.98	\$2,659.34	\$7,978.02

**BID TABULATION FOR:**

CONSTRUCTION OF THE WATER, SANITARY SEWER, AND DRAINAGE FACILITIES  
 TO SERVE TAVOLA SECTION 27  
 EAST MONTGOMERY COUNTY MUNICIPAL UTILITY DISTRICT NO. 6  
 MONTGOMERY, COUNTY, TEXAS  
 FEBRUARY 11, 2020  
 LJA ENGINEERING, INC.  
 E. MURPHY  
 FEBRUARY 12, 2020  
 6966-1227 (9.2)

**BID OPENING DATE:**  
**BID OPENING LOCATION:**  
**TABULATION BY:**  
**TABULATION DATE:**  
**LJA JOB NO.**

ITEM	DESCRIPTION	UNIT	QTY	1) CROSTEX CONSTRUCTION, INC.		2) C.E. BARKER, LTD.		3) BLAZEY CONSTRUCTION SERVICES, LLC	
				UNIT COST	TOTAL COST	UNIT COST	TOTAL COST	UNIT COST	TOTAL COST
10.	STAGE 2 – TYPE C-2 REINFORCED CONCRETE PRECAST CURB INLET, ALL DEPTHS, INCLUDES INLET PROTECTION BARRIER FOR STAGE 2 INLETS, COMPLETE IN PLACE	EA	3	\$1,600.00	\$4,800.00	\$1,469.31	\$4,407.93	\$1,358.05	\$4,074.15
11.	TYPE "C" MANHOLE FOR 42" STORM SEWER AND SMALLER, ALL DEPTHS, COMPLETE IN PLACE	EA	10	\$2,100.00	\$21,000.00	\$2,631.60	\$26,316.00	\$2,365.61	\$23,656.10
12.	TYPE "C" MANHOLE FOR 48" STORM SEWER AND LARGER, ALL DEPTHS, COMPLETE IN PLACE	EA	6	\$3,400.00	\$20,400.00	\$3,563.63	\$21,381.78	\$4,136.92	\$24,821.52
13.	TYPE "C" MANHOLE FOR 48" STORM SEWER AND LARGER WITH TYPE "E" INLET TOP, COMPLETE IN PLACE	EA	1	\$5,500.00	\$5,500.00	\$4,386.00	\$4,386.00	\$6,129.98	\$6,129.98
14.	DEWATERING, ALL SIZES, ALL DEPTHS, (THIS IS AN ESTIMATED QUANTITY TO BE USED ONLY AT THE WRITTEN DIRECTION OF THE ENGINEER), COMPLETE IN PLACE	LF	500	\$20.00	\$10,000.00	\$20.00	\$10,000.00	\$20.00	\$10,000.00
15.	ADDITIONAL COST FOR MODIFIED "A-A" BEDDING, (TO BE USED ONLY AT THE WRITTEN DIRECTION OF THE ENGINEER), ALL SIZES, ALL DEPTHS, COMPLETE IN PLACE	LF	500	\$12.00	\$6,000.00	\$12.00	\$6,000.00	\$12.00	\$6,000.00
16.	WATER, SANITARY SEWER, AND STORM SEWER UTILITY SPOIL TO BE HAULED TO A DESIGNATED STOCKPILE LOCATION WITHIN 2.0 MILE OF THE PROJECT, PLACED AND COMPACTED TO 95% STANDARD PROCTOR DENSITY, INCLUDES SITE PREP, ANY TEMPORARY TRAFFIC CONTROL, FLAGMEN, ETC., REQUIRED TO CROSS OR TRAVERSE EXISTING ROADWAYS, COMPLETE IN PLACE	CY	5,074	\$6.00	\$30,444.00	\$2.31	\$11,720.94	\$4.86	\$24,659.64
17.	TRENCH SAFETY SYSTEM, ALL DEPTHS, COMPLETE IN PLACE	LF	2,773	\$0.05	\$138.65	\$0.11	\$305.03	\$0.27	\$748.71
18.	INSTALLATION, MAINTENANCE AND REMOVAL OF STABILIZED CONSTRUCTION EXIT, SWMHCA SPECIFICATION NO. 4711, (TO BE USED ONLY AS DIRECTED BY THE ENGINEER), COMPLETE IN PLACE	LS	1	\$1,500.00	\$1,500.00	\$1,500.00	\$1,500.00	\$1,500.00	\$1,500.00
19.	STORM WATER POLLUTION PREVENTION PLAN, INCLUDES CONTRACTOR'S BOOKLET NOI & NOT, COMPLETE IN PLACE	LS	1	\$553.52	\$553.52	\$548.25	\$548.25	\$620.47	\$620.47
20.	METHOD "A" FULL CONSTRUCTION STAKING (BY GBI SURVEYING COORDINATE WITH JON BORDOVSKY: 281.499.4539), OWNER ONLY PROVIDES LIMITED CONTROL STAKING, COMPLETE IN PLACE	LS	1	\$6,500.00	\$6,500.00	\$6,453.00	\$6,453.00	\$6,453.00	\$6,453.00
21.	CONCRETE TRUCK WASHOUT, COMPLETE IN PLACE	EA	1	\$250.00	\$250.00	\$1,096.50	\$1,096.50	\$647.45	\$647.45
22.	OVERFLOW V-BOTTOM SWALE AS SHOWN IN THE CONSTRUCTION PLANS, COMPLETE IN PLACE	LF	178	\$3.50	\$623.00	\$6.85	\$1,219.30	\$7.19	\$1,279.82
23.	8" BRICK WALL PLUG FOR STORM SEWER, ALL SIZES, COMPLETE IN PLACE	EA	1	\$200.00	\$200.00	\$328.95	\$328.95	\$80.93	\$80.93
24.	REMOVE AND DISPOSE OF EXISTING MANHOLE #D-202 AND EXISTING 30" H.D.P.E. STORM SEWER, COMPLETE IN PLACE	LS	1	\$500.00	\$500.00	\$1,918.88	\$1,918.88	\$1,294.90	\$1,294.90
25.	REMOVE AND DISPOSE OF EXISTING OUTFALL, COMPLETE IN PLACE	LS	1	\$1,000.00	\$1,000.00	\$1,096.50	\$1,096.50	\$1,294.90	\$1,294.90
26.	REMOVE AND DISPOSE OF 8" BRICK WALL PLUG #D-1000 AND CONNECT PROPOSED 60" R.C.P. STORM SEWER, COMPLETE IN PLACE	LS	1	\$500.00	\$500.00	\$1,644.75	\$1,644.75	\$3.95	\$3.95
27.	BORE AND JACK OR AUGER SECTION FOR 60" RCP STORM SEWER INCLUDING DRY AND WET CONDITIONS, ALL DEPTHS, (DOES NOT INCLUDE RCP), COMPLETE IN PLACE	LF	7	\$1,250.00	\$8,750.00	\$744.05	\$5,208.35	\$1,133.03	\$7,931.21
28.	CONSTRUCT PROPOSED TYPE 'C' MANHOLE #D-202A OVER EXISTING 30" RCP STORM SEWER, COMPLETE IN PLACE	EA	1	\$2,400.00	\$2,400.00	\$2,905.73	\$2,905.73	\$3,744.41	\$3,744.41

**BID TABULATION FOR:**

**BID OPENING DATE:**  
**BID OPENING LOCATION:**  
**TABULATION BY:**  
**TABULATION DATE:**  
**LJA JOB NO.**

CONSTRUCTION OF THE WATER, SANITARY SEWER, AND DRAINAGE FACILITIES  
 TO SERVE TAVOLA SECTION 27  
 EAST MONTGOMERY COUNTY MUNICIPAL UTILITY DISTRICT NO. 6  
 MONTGOMERY, COUNTY, TEXAS  
 FEBRUARY 11, 2020  
 LJA ENGINEERING, INC.  
 E. MURPHY  
 FEBRUARY 12, 2020  
 6966-1227 (9.2)

ITEM DESCRIPTION	UNIT	QTY	1) CROSTEX CONSTRUCTION, INC.		2) C.E. BARKER, LTD.		3) BLAZEY CONSTRUCTION SERVICES, LLC		
			UNIT COST	TOTAL COST	UNIT COST	TOTAL COST	UNIT COST	TOTAL COST	
29. TYPE 'E' INLET, COMPLETE IN PLACE	EA	1	\$2,700.00	\$2,700.00	\$2,346.51	\$2,346.51	\$3,021.42	\$3,021.42	
<b>SUBTOTAL DRAINAGE FACILITIES ITEMS</b>				<b>\$462,000.02</b>		<b>\$494,934.85</b>		<b>\$486,271.21</b>	
<b>MISCELLANEOUS ITEMS</b>									
1. ADJUST EXISTING MANHOLE RIM ELEVATION AS REQUIRED, (TO BE USED ONLY AT THE DIRECTION OF THE ENGINEER), COMPLETE IN PLACE	EA	1	\$150.00	\$150.00	\$566.53	\$566.53	\$539.54	\$539.54	
2. STORMWATER POLLUTION INSPECTION REPORTS CONDUCTED ON A WEEKLY BASIS ACCORDING TO TCEQ PERMIT, COMPLETE IN PLACE	LS	1	\$500.00	\$500.00	\$548.25	\$548.25	\$550.00	\$550.00	
3. DEDUCT FOR DAMAGE TO TREES OUTSIDE CLEARING LIMITS OR MARKED FOR PRESERVATION, COMPLETE IN PLACE	EA	0	(\$1,000.00)	\$0.00	(\$1,000.00)	\$0.00	(\$1,000.00)	\$0.00	
4. DEDUCT FOR DAMAGE TO OWNER INSTALLED EROSION CONTROL FENCE, COMPLETE IN PLACE	LF	0	(\$2.00)	\$0.00	(\$2.00)	\$0.00	(\$2.00)	\$0.00	
<b>SUBTOTAL MISCELLANEOUS ITEMS</b>				<b>\$650.00</b>		<b>\$1,114.78</b>		<b>\$1,089.54</b>	
<b>BID SUMMARY</b>									
SUBTOTAL WATER ITEMS				\$74,908.00		\$71,815.25		\$67,719.86	
SUBTOTAL SANITARY SEWER ITEMS				\$129,441.98		\$116,901.00		\$138,626.69	
SUBTOTAL DRAINAGE FACILITIES ITEMS				\$462,000.02		\$494,934.85		\$486,271.21	
SUBTOTAL MISCELLANEOUS ITEMS				\$650.00		\$1,114.78		\$1,089.54	
<b>TOTAL AMOUNT BID</b>				<b>\$667,000.00</b>		<b>\$684,765.88</b>		<b>\$693,707.30</b>	

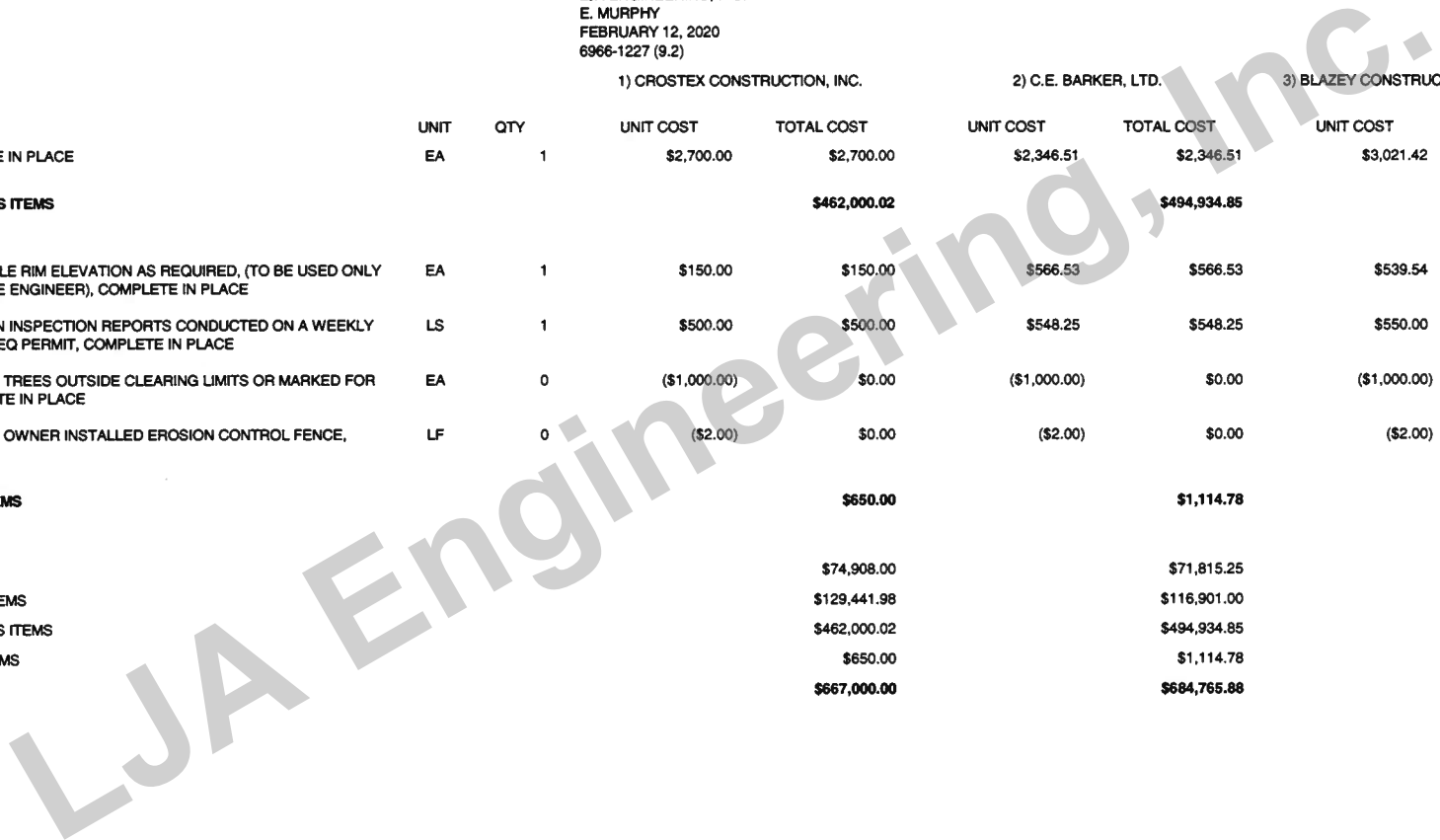

**BID TABULATION FOR:**

**BID OPENING DATE:**  
**BID OPENING LOCATION:**  
**TABULATION BY:**  
**TABULATION DATE:**  
**LJA JOB NO.**

CONSTRUCTION OF THE WATER, SANITARY SEWER, AND DRAINAGE FACILITIES  
 TO SERVE TAVOLA SECTION 27  
 EAST MONTGOMERY COUNTY MUNICIPAL UTILITY DISTRICT NO. 6  
 MONTGOMERY, COUNTY, TEXAS  
 FEBRUARY 11, 2020  
 LJA ENGINEERING, INC.  
 E. MURPHY  
 FEBRUARY 12, 2020  
 6966-1227 (9.2)

ITEM DESCRIPTION	UNIT	QTY	4) PRINCIPAL SERVICES, LTD.		5) TEXASITE, LLC		6) R CONSTRUCTION CIVIL, LLC DBA R CONSTRUCTION COMPANY		
			UNIT COST	TOTAL COST	UNIT COST	TOTAL COST	UNIT COST	TOTAL COST	
<b>WATER ITEMS</b>									
1. 8" P.V.C. WATER PIPE, C-900, DR 18, CLASS 235, ALL DEPTHS, COMPLETE IN PLACE	LF	1,743	\$17.00	\$29,631.00	\$17.00	\$29,631.00	\$16.00	\$27,888.00	
2. 12" P.V.C WATER PIPE, C-900, DR 18, CLASS 235, ALL DEPTHS, COMPLETE IN PLACE	LF	30	\$26.00	\$780.00	\$28.00	\$840.00	\$35.00	\$1,050.00	
3. FIRE HYDRANT UNIT, ALL DEPTHS, INCLUDES APPROPRIATE TEE, 6" GATE VALVE & BOX, 6" LEAD AND FIRE HYDRANT, COMPLETE IN PLACE	EA	7	\$3,000.00	\$21,000.00	\$3,300.00	\$23,100.00	\$3,900.00	\$27,300.00	
4. 8" AWWA GATE VALVE AND BOX, COMPLETE IN PLACE	EA	8	\$900.00	\$7,200.00	\$1,000.00	\$8,000.00	\$900.00	\$7,200.00	
5. DUCTILE IRON FITTINGS, COMPLETE IN PLACE	TON	0.93	\$2,500.00	\$2,325.00	\$4,300.00	\$3,999.00	\$2,300.00	\$2,139.00	
6. 4" P.V.C. WATER PIPE, C-900, DR 18, CLASS 235, RESTRAINED JOINT, ALL DEPTHS, COMPLETE IN PLACE	LF	76	\$16.00	\$1,216.00	\$18.00	\$1,368.00	\$22.00	\$1,672.00	
7. 6" P.V.C. WATER PIPE, C-900, DR 18, CLASS 235, RESTRAINED JOINT, ALL DEPTHS, COMPLETE IN PLACE	LF	287	\$19.00	\$5,453.00	\$20.00	\$5,740.00	\$25.00	\$7,175.00	
8. 8" P.V.C. WATER PIPE, C-900, DR-18, CLASS 235, RESTRAINED JOINT, ALL DEPTHS, COMPLETE IN PLACE	LF	245	\$26.00	\$6,370.00	\$27.00	\$6,615.00	\$30.00	\$7,350.00	
9. TRENCH SAFETY SYSTEM, ALL DEPTHS, COMPLETE IN PLACE	LF	2,381	\$0.10	\$238.10	\$1.00	\$2,381.00	\$0.10	\$238.10	
10. 8" PLUG AND CLAMP, COMPLETE IN PLACE	EA	3	\$200.00	\$600.00	\$250.00	\$750.00	\$100.00	\$300.00	
11. 2" BLOW-OFF VALVE & BOX ASSEMBLY, COMPLETE IN PLACE	EA	4	\$800.00	\$3,200.00	\$500.00	\$2,000.00	\$800.00	\$3,200.00	
12. 4" PLUG AND CLAMP, COMPLETE IN PLACE	EA	1	\$150.00	\$150.00	\$250.00	\$250.00	\$100.00	\$100.00	
13. REMOVE 12" PLUG AND CLAMP AND 2" BLOW OFF VALVE AND BOX AND CONNECT PROPOSED 12" WATER LINE INCLUDES ALL NECESSARY ADAPTERS, AND CONNECTORS (WET CONNECT), COMPLETE IN PLACE	EA	1	\$400.00	\$400.00	\$300.00	\$300.00	\$250.00	\$250.00	
14. 14" STEEL CASING FOR 8" WATER LINE, (EXCLUDES PVC CARRIER PIPE), COMPLETE IN PLACE	LF	20	\$89.00	\$1,780.00	\$65.00	\$1,300.00	\$59.00	\$1,180.00	
<b>SUBTOTAL WATER ITEMS</b>				<b>\$80,343.10</b>		<b>\$86,274.00</b>		<b>\$87,042.10</b>	
<b>SANITARY SEWER ITEMS</b>									
1. 8" P.V.C. GREEN SEWER PIPE, ASTM D-2241, SDR 26, 0'-8' CUT, COMPLETE IN PLACE	LF	1,570	\$20.00	\$31,400.00	\$34.00	\$53,380.00	\$24.00	\$37,680.00	
2. 8" P.V.C. GREEN SEWER PIPE, ASTM D-2241, SDR 26, 8' - 12' CUT, COMPLETE IN PLACE	LF	158	\$21.00	\$3,318.00	\$35.00	\$5,530.00	\$26.00	\$4,108.00	
3. EXTRA DEPTH OF SANITARY MANHOLE, (OVER 8' DEPTH), COMPLETE IN PLACE	VF	0.48	\$140.00	\$67.20	\$155.00	\$74.40	\$125.00	\$60.00	
4. STANDARD SANITARY SEWER MANHOLE FOR 6"-24" SANITARY SEWER PIPES, (0' - 8' DEPTH), INCLUDES INFLOW PROTECTOR, COMPLETE IN PLACE	EA	12	\$1,800.00	\$21,600.00	\$2,200.00	\$26,400.00	\$1,900.00	\$22,800.00	
5. "LONG SIDE" DOUBLE OR SINGLE 6" PVC PIPE SERVICE LEADS, ASTM D-2241, SDR 26, CLASS 160, ALL DEPTHS, INCLUDING DROP STRUCTURE, CEMENT STABILIZED SAND BACKFILL, STACK, RISER, WYE, PLUG, MARKER, AND ANY NECESSARY FITTINGS, ETC., COMPLETE IN PLACE	LF	881	\$26.00	\$22,906.00	\$30.00	\$26,430.00	\$35.00	\$30,835.00	

**BID TABULATION FOR:**

**BID OPENING DATE:**  
**BID OPENING LOCATION:**  
**TABULATION BY:**  
**TABULATION DATE:**  
**LJA JOB NO.**

CONSTRUCTION OF THE WATER, SANITARY SEWER, AND DRAINAGE FACILITIES  
 TO SERVE TAVOLA SECTION 27  
 EAST MONTGOMERY COUNTY MUNICIPAL UTILITY DISTRICT NO. 6  
 MONTGOMERY, COUNTY, TEXAS  
 FEBRUARY 11, 2020  
 LJA ENGINEERING, INC.  
 E. MURPHY  
 FEBRUARY 12, 2020  
 6966-1227 (9.2)

ITEM	DESCRIPTION	UNIT	QTY	4) PRINCIPAL SERVICES, LTD.		5) TEXASITE, LLC		6) R CONSTRUCTION CIVIL, LLC DBA R CONSTRUCTION COMPANY	
				UNIT COST	TOTAL COST	UNIT COST	TOTAL COST	UNIT COST	TOTAL COST
6.	"SHORT SIDE" DOUBLE OR SINGLE 6" PVC PIPE SERVICE LEADS, ASTM D-2241, SDR 26, CLASS 160, ALL DEPTHS, INCLUDING CEMENT STABILIZED SAND BACKFILL, RISER, WYE, PLUG, DROP STRUCTURE, MARKER, AND ANY NECESSARY FITTINGS, ETC., COMPLETE IN PLACE	EA	15	\$1,100.00	\$16,500.00	\$650.00	\$9,750.00	\$1,000.00	\$15,000.00
7.	T.V. INSPECTION OF SANITARY SEWER LINES, (TO BE USED ONLY AT THE WRITTEN DIRECTION OF THE ENGINEER), COMPLETE IN PLACE	LF	1,728	\$3.00	\$5,184.00	\$0.01	\$17.28	\$1.50	\$2,592.00
8.	TRENCH SAFETY SYSTEM, ALL DEPTHS, COMPLETE IN PLACE	LF	2,609	\$0.10	\$260.90	\$1.00	\$2,609.00	\$0.10	\$260.90
9.	DEWATERING FOR SANITARY SEWER, ALL SIZES, ALL DEPTHS, (TO BE USED ONLY AS DIRECTED BY THE ENGINEER), COMPLETE IN PLACE	LF	500	\$25.00	\$12,500.00	\$20.00	\$10,000.00	\$20.00	\$10,000.00
10.	ADDITIONAL COST FOR MODIFIED "A-A" BEDDING FOR WET SAND CONSTRUCTION, ALL DEPTHS, ALL SIZES, (TO BE USED ONLY AS DIRECTED BY THE ENGINEER), COMPLETE IN PLACE	LF	500	\$12.00	\$6,000.00	\$12.00	\$6,000.00	\$12.00	\$6,000.00
11.	CORE INTO EXISTING SANITARY SEWER MANHOLE AND CONNECT PROPOSED 8" SANITARY SEWER, INCLUDES ALL NECESSARY CONNECTORS, ADAPTERS AND FITTINGS, COMPLETE IN PLACE	EA	3	\$1,500.00	\$4,500.00	\$1,100.00	\$3,300.00	\$1,000.00	\$3,000.00
12.	ADJUST EXISTING SANITARY MANHOLE TO 6" ABOVE TOP OF CURB, COMPLETE IN PLACE	EA	3	\$1,000.00	\$3,000.00	\$100.00	\$300.00	\$350.00	\$1,050.00
13.	REMOVE AND DISPOSE OF 8" SANITARY SEWER, COMPLETE IN PLACE	LF	26	\$25.00	\$650.00	\$45.00	\$1,170.00	\$50.00	\$1,300.00
14.	8" SANITARY SEWER PLUG, COMPLETE IN PLACE	EA	1	\$200.00	\$200.00	\$100.00	\$100.00	\$50.00	\$50.00
<b>SUBTOTAL SANITARY SEWER ITEMS</b>					<b>\$128,086.10</b>	<b>\$145,060.68</b>	<b>\$134,735.90</b>		
<b>DRAINAGE FACILITIES ITEMS</b>									
1.	24" R.C.P. STORM SEWER, ASTM C-76, CLASS III, ALL DEPTHS, COMPLETE IN PLACE	LF	741	\$56.00	\$41,496.00	\$54.00	\$40,014.00	\$68.00	\$50,388.00
2.	30" R.C.P. STORM SEWER, ASTM C-76, CLASS III, ALL DEPTHS, COMPLETE IN PLACE	LF	457	\$70.00	\$31,990.00	\$68.00	\$31,076.00	\$82.00	\$37,474.00
3.	36" R.C.P. STORM SEWER, ASTM C-76, CLASS III, ALL DEPTHS, COMPLETE IN PLACE	LF	611	\$99.00	\$60,489.00	\$95.00	\$58,045.00	\$110.00	\$67,210.00
4.	48" R.C.P. STORM SEWER, ASTM C-76, CLASS III, ALL DEPTHS, COMPLETE IN PLACE	LF	317	\$153.00	\$48,501.00	\$157.00	\$49,769.00	\$162.00	\$51,354.00
5.	54" R.C.P. STORM SEWER, ASTM C-76, CLASS III, ALL DEPTHS, COMPLETE IN PLACE	LF	299	\$212.00	\$63,388.00	\$207.00	\$61,893.00	\$226.00	\$67,574.00
6.	60" R.C.P. STORM SEWER, ASTM C-76, CLASS III, ALL DEPTHS, COMPLETE IN PLACE	LF	348	\$245.00	\$85,260.00	\$425.00	\$147,900.00	\$284.00	\$98,832.00
7.	STAGE I – STANDARD 5' PRECAST INLET ("B-B"), (INCLUDES TEMPORARY SAND FILLED BURLAP BAGS FOR EROSION AND SEDIMENT CONTROL), COMPLETE IN PLACE	EA	10	\$900.00	\$9,000.00	\$1,300.00	\$13,000.00	\$800.00	\$8,000.00
8.	STAGE II – STANDARD 5' PRECAST INLET ("B-B"), (INCLUDES TEMPORARY SAND-FILLED BURLAP BAGS FOR EROSION AND SEDIMENT CONTROL), COMPLETE IN PLACE	EA	10	\$1,500.00	\$15,000.00	\$1,300.00	\$13,000.00	\$1,400.00	\$14,000.00
9.	STAGE 1- TYPE C-2 REINFORCED CONCRETE PRECAST CURB INLET, ALL DEPTHS, INCLUDES INLET PROTECTION BARRIER FOR STAGE 1 INLETS, COMPLETE IN PLACE	EA	3	\$900.00	\$2,700.00	\$1,300.00	\$3,900.00	\$2,600.00	\$7,800.00

**BID TABULATION FOR:**

**BID OPENING DATE:**  
**BID OPENING LOCATION:**  
**TABULATION BY:**  
**TABULATION DATE:**  
**LJA JOB NO.**

CONSTRUCTION OF THE WATER, SANITARY SEWER, AND DRAINAGE FACILITIES  
 TO SERVE TAVOLA SECTION 27  
 EAST MONTGOMERY COUNTY MUNICIPAL UTILITY DISTRICT NO. 6  
 MONTGOMERY, COUNTY, TEXAS  
 FEBRUARY 11, 2020  
 LJA ENGINEERING, INC.  
 E. MURPHY  
 FEBRUARY 12, 2020  
 6966-1227 (9.2)

ITEM	DESCRIPTION	UNIT	QTY	4) PRINCIPAL SERVICES, LTD.		5) TEXASITE, LLC		6) R CONSTRUCTION CIVIL, LLC DBA R CONSTRUCTION COMPANY	
				UNIT COST	TOTAL COST	UNIT COST	TOTAL COST	UNIT COST	TOTAL COST
10.	STAGE 2 – TYPE C-2 REINFORCED CONCRETE PRECAST CURB INLET, ALL DEPTHS, INCLUDES INLET PROTECTION BARRIER FOR STAGE 2 INLETS, COMPLETE IN PLACE	EA	3	\$2,100.00	\$6,300.00	\$2,700.00	\$8,100.00	\$2,700.00	\$8,100.00
11.	TYPE "C" MANHOLE FOR 42" STORM SEWER AND SMALLER, ALL DEPTHS, COMPLETE IN PLACE	EA	10	\$2,500.00	\$25,000.00	\$2,300.00	\$23,000.00	\$2,200.00	\$22,000.00
12.	TYPE "C" MANHOLE FOR 48" STORM SEWER AND LARGER, ALL DEPTHS, COMPLETE IN PLACE	EA	6	\$4,400.00	\$26,400.00	\$3,700.00	\$22,200.00	\$4,260.00	\$25,560.00
13.	TYPE "C" MANHOLE FOR 48" STORM SEWER AND LARGER WITH TYPE "E" INLET TOP, COMPLETE IN PLACE	EA	1	\$6,600.00	\$6,600.00	\$4,000.00	\$4,000.00	\$6,400.00	\$6,400.00
14.	DEWATERING, ALL SIZES, ALL DEPTHS, (THIS IS AN ESTIMATED QUANTITY TO BE USED ONLY AT THE WRITTEN DIRECTION OF THE ENGINEER), COMPLETE IN PLACE	LF	500	\$25.00	\$12,500.00	\$20.00	\$10,000.00	\$20.00	\$10,000.00
15.	ADDITIONAL COST FOR MODIFIED "A-A" BEDDING, (TO BE USED ONLY AT THE WRITTEN DIRECTION OF THE ENGINEER), ALL SIZES, ALL DEPTHS, COMPLETE IN PLACE	LF	500	\$12.00	\$6,000.00	\$12.00	\$6,000.00	\$12.00	\$6,000.00
16.	WATER, SANITARY SEWER, AND STORM SEWER UTILITY SPOIL TO BE HAULED TO A DESIGNATED STOCKPILE LOCATION WITHIN 2.0 MILE OF THE PROJECT, PLACED AND COMPACTED TO 95% STANDARD PROCTOR DENSITY, INCLUDES SITE PREP, ANY TEMPORARY TRAFFIC CONTROL, FLAGMEN, ETC., REQUIRED TO CROSS OR TRAVERSE EXISTING ROADWAYS, COMPLETE IN PLACE	CY	5,074	\$5.00	\$25,370.00	\$1.00	\$5,074.00	\$5.00	\$25,370.00
17.	TRENCH SAFETY SYSTEM, ALL DEPTHS, COMPLETE IN PLACE	LF	2,773	\$0.10	\$277.30	\$1.00	\$2,773.00	\$0.10	\$277.30
18.	INSTALLATION, MAINTENANCE AND REMOVAL OF STABILIZED CONSTRUCTION EXIT, SWMHCA SPECIFICATION NO. 4711, (TO BE USED ONLY AS DIRECTED BY THE ENGINEER), COMPLETE IN PLACE	LS	1	\$1,500.00	\$1,500.00	\$1,500.00	\$1,500.00	\$1,500.00	\$1,500.00
19.	STORM WATER POLLUTION PREVENTION PLAN, INCLUDES CONTRACTOR'S BOOKLET NOI & NOT, COMPLETE IN PLACE	LS	1	\$1,000.00	\$1,000.00	\$900.00	\$900.00	\$1,100.00	\$1,100.00
20.	METHOD "A" FULL CONSTRUCTION STAKING (BY GBI SURVEYING COORDINATE WITH JON BORDOVSKY: 281.499.4539), OWNER ONLY PROVIDES LIMITED CONTROL STAKING, COMPLETE IN PLACE	LS	1	\$6,453.00	\$6,453.00	\$6,453.00	\$6,453.00	\$6,453.00	\$6,453.00
21.	CONCRETE TRUCK WASHOUT, COMPLETE IN PLACE	EA	1	\$1,000.00	\$1,000.00	\$1.00	\$1.00	\$500.00	\$500.00
22.	OVERFLOW V-BOTTOM SWALE AS SHOWN IN THE CONSTRUCTION PLANS, COMPLETE IN PLACE	LF	178	\$15.00	\$2,670.00	\$6.00	\$1,068.00	\$5.00	\$890.00
23.	8" BRICK WALL PLUG FOR STORM SEWER, ALL SIZES, COMPLETE IN PLACE	EA	1	\$200.00	\$200.00	\$400.00	\$400.00	\$500.00	\$500.00
24.	REMOVE AND DISPOSE OF EXISTING MANHOLE #D-202 AND EXISTING 30" H.D.P.E. STORM SEWER, COMPLETE IN PLACE	LS	1	\$6,000.00	\$6,000.00	\$3,250.00	\$3,250.00	\$4,200.00	\$4,200.00
25.	REMOVE AND DISPOSE OF EXISTING OUTFALL, COMPLETE IN PLACE	LS	1	\$6,500.00	\$6,500.00	\$2,700.00	\$2,700.00	\$5,800.00	\$5,800.00
26.	REMOVE AND DISPOSE OF 8" BRICK WALL PLUG #D-1000 AND CONNECT PROPOSED 60" R.C.P. STORM SEWER, COMPLETE IN PLACE	LS	1	\$500.00	\$500.00	\$500.00	\$500.00	\$1,200.00	\$1,200.00
27.	BORE AND JACK OR AUGER SECTION FOR 60" RCP STORM SEWER INCLUDING DRY AND WET CONDITIONS, ALL DEPTHS, (DOES NOT INCLUDE RCP), COMPLETE IN PLACE	LF	7	\$2,500.00	\$17,500.00	\$100.00	\$700.00	\$1,036.00	\$7,252.00
28.	CONSTRUCT PROPOSED TYPE 'C' MANHOLE #D-202A OVER EXISTING 30" RCP STORM SEWER, COMPLETE IN PLACE	EA	1	\$2,200.00	\$2,200.00	\$2,700.00	\$2,700.00	\$4,400.00	\$4,400.00



**BID TABULATION FOR:**

CONSTRUCTION OF THE WATER, SANITARY SEWER, AND DRAINAGE FACILITIES  
 TO SERVE TAVOLA SECTION 27  
 EAST MONTGOMERY COUNTY MUNICIPAL UTILITY DISTRICT NO. 6  
 MONTGOMERY, COUNTY, TEXAS  
 FEBRUARY 11, 2020  
 LJA ENGINEERING, INC.  
 E. MURPHY  
 FEBRUARY 12, 2020  
 6966-1227 (9.2)

**BID OPENING DATE:**  
**BID OPENING LOCATION:**  
**TABULATION BY:**  
**TABULATION DATE:**  
**LJA JOB NO.**

ITEM DESCRIPTION	UNIT	QTY	4) PRINCIPAL SERVICES, LTD.		5) TEXASITE, LLC		6) R CONSTRUCTION CIVIL, LLC DBA R CONSTRUCTION COMPANY		
			UNIT COST	TOTAL COST	UNIT COST	TOTAL COST	UNIT COST	TOTAL COST	
29. TYPE 'E' INLET, COMPLETE IN PLACE	EA	1	\$1,776.50	\$1,776.50	\$2,600.00	\$2,600.00	\$2,900.00	\$2,900.00	
<b>SUBTOTAL DRAINAGE FACILITIES ITEMS</b>				<b>\$513,570.80</b>	<b>\$522,516.00</b>			<b>\$543,034.30</b>	
<b>MISCELLANEOUS ITEMS</b>									
1. ADJUST EXISTING MANHOLE RIM ELEVATION AS REQUIRED, (TO BE USED ONLY AT THE DIRECTION OF THE ENGINEER), COMPLETE IN PLACE	EA	1	\$1,000.00	\$1,000.00	\$100.00	\$100.00	\$350.00	\$350.00	
2. STORMWATER POLLUTION INSPECTION REPORTS CONDUCTED ON A WEEKLY BASIS ACCORDING TO TCEQ PERMIT, COMPLETE IN PLACE	LS	1	\$1,000.00	\$1,000.00	\$800.00	\$800.00	\$600.00	\$600.00	
3. DEDUCT FOR DAMAGE TO TREES OUTSIDE CLEARING LIMITS OR MARKED FOR PRESERVATION, COMPLETE IN PLACE	EA	0	(\$1,000.00)	\$0.00	(\$1,000.00)	\$0.00	(\$1,000.00)	\$0.00	
4. DEDUCT FOR DAMAGE TO OWNER INSTALLED EROSION CONTROL FENCE, COMPLETE IN PLACE	LF	0	(\$2.00)	\$0.00	(\$2.00)	\$0.00	(\$2.00)	\$0.00	
<b>SUBTOTAL MISCELLANEOUS ITEMS</b>				<b>\$2,000.00</b>	<b>\$900.00</b>			<b>\$950.00</b>	
<b>BID SUMMARY</b>									
SUBTOTAL WATER ITEMS				\$80,343.10	\$86,274.00			\$87,042.10	
SUBTOTAL SANITARY SEWER ITEMS				\$128,086.10	\$145,060.68			\$134,735.90	
SUBTOTAL DRAINAGE FACILITIES ITEMS				\$513,570.80	\$522,516.00			\$543,034.30	
SUBTOTAL MISCELLANEOUS ITEMS				\$2,000.00	\$900.00			\$950.00	
<b>TOTAL AMOUNT BID</b>				<b>\$724,000.00</b>	<b>\$754,750.68</b>			<b>\$765,762.30</b>	

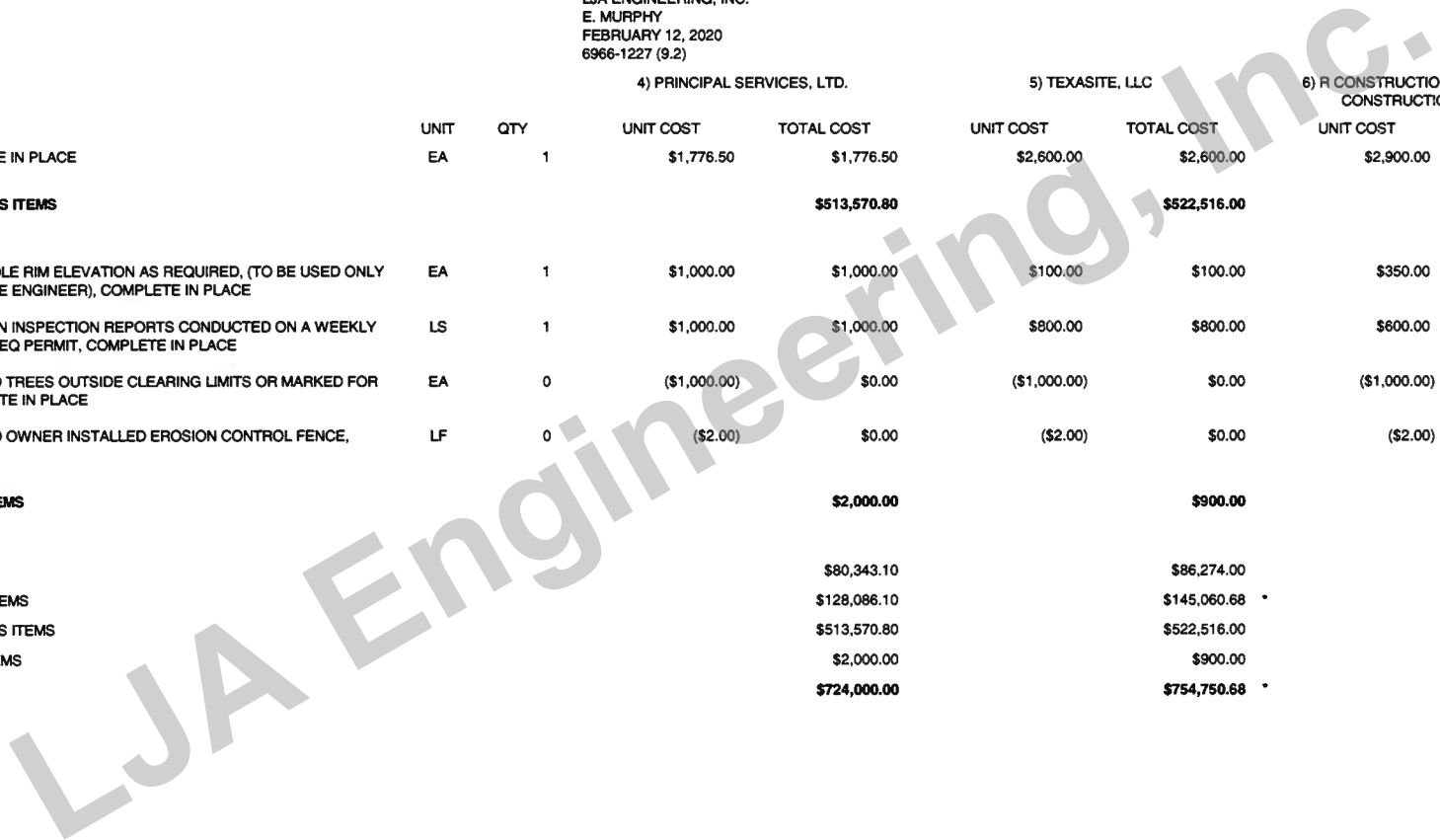

**BID TABULATION FOR:**

**BID OPENING DATE:**  
**BID OPENING LOCATION:**  
**TABULATION BY:**  
**TABULATION DATE:**  
**LJA JOB NO.**

CONSTRUCTION OF THE WATER, SANITARY SEW  
 TO SERVE TAVOLA SECTION 27  
 EAST MONTGOMERY COUNTY MUNICIPAL UTILIT  
 MONTGOMERY, COUNTY, TEXAS  
 FEBRUARY 11, 2020  
 LJA ENGINEERING, INC.  
 E. MURPHY  
 FEBRUARY 12, 2020  
 6966-1227 (9.2)

7) PRECISE SERVICES, INC.

ITEM DESCRIPTION	UNIT	QTY	UNIT COST	TOTAL COST
<b>WATER ITEMS</b>				
1. 8" P.V.C. WATER PIPE, C-900, DR 18, CLASS 235, ALL DEPTHS, COMPLETE IN PLACE	LF	1,743	\$19.00	\$33,117.00
2. 12" P.V.C WATER PIPE, C-900, DR 18, CLASS 235, ALL DEPTHS, COMPLETE IN PLACE	LF	30	\$36.00	\$1,080.00
3. FIRE HYDRANT UNIT, ALL DEPTHS, INCLUDES APPROPRIATE TEE, 6" GATE VALVE & BOX, 6" LEAD AND FIRE HYDRANT, COMPLETE IN PLACE	EA	7	\$4,050.00	\$28,350.00
4. 8" AWWA GATE VALVE AND BOX, COMPLETE IN PLACE	EA	8	\$1,150.00	\$9,200.00
5. DUCTILE IRON FITTINGS, COMPLETE IN PLACE	TON	0.93	\$2,750.00	\$2,557.50
6. 4" P.V.C. WATER PIPE, C-900, DR 18, CLASS 235, RESTRAINED JOINT, ALL DEPTHS, COMPLETE IN PLACE	LF	76	\$18.50	\$1,406.00
7. 6" P.V.C. WATER PIPE, C-900, DR 18, CLASS 235, RESTRAINED JOINT, ALL DEPTHS, COMPLETE IN PLACE	LF	287	\$20.50	\$5,883.50
8. 8" P.V.C. WATER PIPE, C-900, DR-18, CLASS 235, RESTRAINED JOINT, ALL DEPTHS, COMPLETE IN PLACE	LF	245	\$27.50	\$6,737.50
9. TRENCH SAFETY SYSTEM, ALL DEPTHS, COMPLETE IN PLACE	LF	2,381	\$0.10	\$238.10
10. 8" PLUG AND CLAMP, COMPLETE IN PLACE	EA	3	\$265.00	\$795.00
11. 2" BLOW-OFF VALVE & BOX ASSEMBLY, COMPLETE IN PLACE	EA	4	\$840.00	\$3,360.00
12. 4" PLUG AND CLAMP, COMPLETE IN PLACE	EA	1	\$215.00	\$215.00
13. REMOVE 12" PLUG AND CLAMP AND 2" BLOW OFF VALVE AND BOX AND CONNECT PROPOSED 12" WATER LINE INCLUDES ALL NECESSARY ADAPTERS, AND CONNECTORS (WET CONNECT), COMPLETE IN PLACE	EA	1	\$495.00	\$495.00
14. 14" STEEL CASING FOR 8" WATER LINE, (EXCLUDES PVC CARRIER PIPE), COMPLETE IN PLACE	LF	20	\$105.00	\$2,100.00
<b>SUBTOTAL WATER ITEMS</b>				<b>\$95,534.60</b>
<b>SANITARY SEWER ITEMS</b>				
1. 8" P.V.C. GREEN SEWER PIPE, ASTM D-2241, SDR 26, 0'-8' CUT, COMPLETE IN PLACE	LF	1,570	\$29.50	\$46,315.00
2. 8" P.V.C. GREEN SEWER PIPE, ASTM D-2241, SDR 26, 8' - 12' CUT, COMPLETE IN PLACE	LF	158	\$29.50	\$4,661.00
3. EXTRA DEPTH OF SANITARY MANHOLE, (OVER 8' DEPTH), COMPLETE IN PLACE	VF	0.48	\$145.00	\$69.60
4. STANDARD SANITARY SEWER MANHOLE FOR 6"-24" SANITARY SEWER PIPES, (0' - 8' DEPTH), INCLUDES INFLOW PROTECTOR, COMPLETE IN PLACE	EA	12	\$2,600.00	\$31,200.00
5. "LONG SIDE" DOUBLE OR SINGLE 6" PVC PIPE SERVICE LEADS, ASTM D-2241, SDR 26, CLASS 160, ALL DEPTHS, INCLUDING DROP STRUCTURE, CEMENT STABILIZED SAND BACKFILL, STACK, RISER, WYE, PLUG, MARKER, AND ANY NECESSARY FITTINGS, ETC., COMPLETE IN PLACE	LF	881	\$33.00	\$29,073.00

**BID TABULATION FOR:**

**BID OPENING DATE:**  
**BID OPENING LOCATION:**  
**TABULATION BY:**  
**TABULATION DATE:**  
**LJA JOB NO.**

CONSTRUCTION OF THE WATER, SANITARY SEW  
 TO SERVE TAVOLA SECTION 27  
 EAST MONTGOMERY COUNTY MUNICIPAL UTILIT  
 MONTGOMERY, COUNTY, TEXAS  
 FEBRUARY 11, 2020  
 LJA ENGINEERING, INC.  
 E. MURPHY  
 FEBRUARY 12, 2020  
 6966-1227 (9.2)

7) PRECISE SERVICES, INC.

ITEM	DESCRIPTION	UNIT	QTY	UNIT COST	TOTAL COST
6.	"SHORT SIDE" DOUBLE OR SINGLE 6" PVC PIPE SERVICE LEADS, ASTM D-2241, SDR 26, CLASS 160, ALL DEPTHS, INCLUDING CEMENT STABILIZED SAND BACKFILL, RISER, WYE, PLUG, DROP STRUCTURE, MARKER, AND ANY NECESSARY FITTINGS, ETC., COMPLETE IN PLACE	EA	15	\$1,400.00	\$21,000.00
7.	T.V. INSPECTION OF SANITARY SEWER LINES, (TO BE USED ONLY AT THE WRITTEN DIRECTION OF THE ENGINEER), COMPLETE IN PLACE	LF	1,728	\$1.30	\$2,246.40
8.	TRENCH SAFETY SYSTEM, ALL DEPTHS, COMPLETE IN PLACE	LF	2,609	\$0.10	\$260.90
9.	DEWATERING FOR SANITARY SEWER, ALL SIZES, ALL DEPTHS, (TO BE USED ONLY AS DIRECTED BY THE ENGINEER), COMPLETE IN PLACE	LF	500	\$25.00	\$12,500.00
10.	ADDITIONAL COST FOR MODIFIED "A-A" BEDDING FOR WET SAND CONSTRUCTION, ALL DEPTHS, ALL SIZES, (TO BE USED ONLY AS DIRECTED BY THE ENGINEER), COMPLETE IN PLACE	LF	500	\$20.00	\$10,000.00
11.	CORE INTO EXISTING SANITARY SEWER MANHOLE AND CONNECT PROPOSED 8" SANITARY SEWER, INCLUDES ALL NECESSARY CONNECTORS, ADAPTERS AND FITTINGS, COMPLETE IN PLACE	EA	3	\$675.00	\$2,025.00
12.	ADJUST EXISTING SANITARY MANHOLE TO 6" ABOVE TOP OF CURB, COMPLETE IN PLACE	EA	3	\$315.00	\$945.00
13.	REMOVE AND DISPOSE OF 8" SANITARY SEWER, COMPLETE IN PLACE	LF	26	\$34.50	\$897.00
14.	8" SANITARY SEWER PLUG, COMPLETE IN PLACE	EA	1	\$230.00	\$230.00
<b>SUBTOTAL SANITARY SEWER ITEMS</b>					<b>\$161,422.90</b>
<b>DRAINAGE FACILITIES ITEMS</b>					
1.	24" R.C.P. STORM SEWER, ASTM C-76, CLASS III, ALL DEPTHS, COMPLETE IN PLACE	LF	741	\$84.00	\$62,244.00
2.	30" R.C.P. STORM SEWER, ASTM C-76, CLASS III, ALL DEPTHS, COMPLETE IN PLACE	LF	457	\$97.00	\$44,329.00
3.	36" R.C.P. STORM SEWER, ASTM C-76, CLASS III, ALL DEPTHS, COMPLETE IN PLACE	LF	611	\$130.00	\$79,430.00
4.	48" R.C.P. STORM SEWER, ASTM C-76, CLASS III, ALL DEPTHS, COMPLETE IN PLACE	LF	317	\$190.00	\$60,230.00
5.	54" R.C.P. STORM SEWER, ASTM C-76, CLASS III, ALL DEPTHS, COMPLETE IN PLACE	LF	299	\$260.00	\$77,740.00
6.	60" R.C.P. STORM SEWER, ASTM C-76, CLASS III, ALL DEPTHS, COMPLETE IN PLACE	LF	348	\$300.00	\$104,400.00
7.	STAGE I – STANDARD 5' PRECAST INLET ("B-B"), (INCLUDES TEMPORARY SAND FILLED BURLAP BAGS FOR EROSION AND SEDIMENT CONTROL), COMPLETE IN PLACE	EA	10	\$1,400.00	\$14,000.00
8.	STAGE II – STANDARD 5' PRECAST INLET ("B-B"), (INCLUDES TEMPORARY SAND-FILLED BURLAP BAGS FOR EROSION AND SEDIMENT CONTROL), COMPLETE IN PLACE	EA	10	\$1,400.00	\$14,000.00
9.	STAGE 1- TYPE C-2 REINFORCED CONCRETE PRECAST CURB INLET, ALL DEPTHS, INCLUDES INLET PROTECTION BARRIER FOR STAGE 1 INLETS, COMPLETE IN PLACE	EA	3	\$3,450.00	\$10,350.00

**BID TABULATION FOR:**

**BID OPENING DATE:**  
**BID OPENING LOCATION:**  
**TABULATION BY:**  
**TABULATION DATE:**  
**LJA JOB NO.**

CONSTRUCTION OF THE WATER, SANITARY SEW  
 TO SERVE TAVOLA SECTION 27  
 EAST MONTGOMERY COUNTY MUNICIPAL UTILIT  
 MONTGOMERY, COUNTY, TEXAS  
 FEBRUARY 11, 2020  
 LJA ENGINEERING, INC.  
 E. MURPHY  
 FEBRUARY 12, 2020  
 6966-1227 (9.2)

7) PRECISE SERVICES, INC.

ITEM	DESCRIPTION	UNIT	QTY	UNIT COST	TOTAL COST
10.	STAGE 2 – TYPE C-2 REINFORCED CONCRETE PRECAST CURB INLET, ALL DEPTHS, INCLUDES INLET PROTECTION BARRIER FOR STAGE 2 INLETS, COMPLETE IN PLACE	EA	3	\$2,250.00	\$6,750.00
11.	TYPE "C" MANHOLE FOR 42" STORM SEWER AND SMALLER, ALL DEPTHS, COMPLETE IN PLACE	EA	10	\$3,350.00	\$33,500.00
12.	TYPE "C" MANHOLE FOR 48" STORM SEWER AND LARGER, ALL DEPTHS, COMPLETE IN PLACE	EA	6	\$5,850.00	\$35,100.00
13.	TYPE "C" MANHOLE FOR 48" STORM SEWER AND LARGER WITH TYPE "E" INLET TOP, COMPLETE IN PLACE	EA	1	\$8,100.00	\$8,100.00
14.	DEWATERING, ALL SIZES, ALL DEPTHS, (THIS IS AN ESTIMATED QUANTITY TO BE USED ONLY AT THE WRITTEN DIRECTION OF THE ENGINEER), COMPLETE IN PLACE	LF	500	\$25.00	\$12,500.00
15.	ADDITIONAL COST FOR MODIFIED "A-A" BEDDING, (TO BE USED ONLY AT THE WRITTEN DIRECTION OF THE ENGINEER), ALL SIZES, ALL DEPTHS, COMPLETE IN PLACE	LF	500	\$20.00	\$10,000.00
16.	WATER, SANITARY SEWER, AND STORM SEWER UTILITY SPOIL TO BE HAULED TO A DESIGNATED STOCKPILE LOCATION WITHIN 2.0 MILE OF THE PROJECT, PLACED AND COMPACTED TO 95% STANDARD PROCTOR DENSITY, INCLUDES SITE PREP, ANY TEMPORARY TRAFFIC CONTROL, FLAGMEN, ETC., REQUIRED TO CROSS OR TRAVERSE EXISTING ROADWAYS, COMPLETE IN PLACE	CY	5,074	\$11.50	\$58,351.00
17.	TRENCH SAFETY SYSTEM, ALL DEPTHS, COMPLETE IN PLACE	LF	2,773	\$0.10	\$277.30
18.	INSTALLATION, MAINTENANCE AND REMOVAL OF STABILIZED CONSTRUCTION EXIT, SWMHCA SPECIFICATION NO. 4711, (TO BE USED ONLY AS DIRECTED BY THE ENGINEER), COMPLETE IN PLACE	LS	1	\$1,600.00	\$1,600.00
19.	STORM WATER POLLUTION PREVENTION PLAN, INCLUDES CONTRACTOR'S BOOKLET NOI & NOT, COMPLETE IN PLACE	LS	1	\$14,000.00	\$14,000.00
20.	METHOD "A" FULL CONSTRUCTION STAKING (BY GBI SURVEYING COORDINATE WITH JON BORDOVSKY: 281.499.4539), OWNER ONLY PROVIDES LIMITED CONTROL STAKING, COMPLETE IN PLACE	LS	1	\$6,453.00	\$6,453.00
21.	CONCRETE TRUCK WASHOUT, COMPLETE IN PLACE	EA	1	\$745.00	\$745.00
22.	OVERFLOW V-BOTTOM SWALE AS SHOWN IN THE CONSTRUCTION PLANS, COMPLETE IN PLACE	LF	178	\$1.50	\$267.00
23.	8" BRICK WALL PLUG FOR STORM SEWER, ALL SIZES, COMPLETE IN PLACE	EA	1	\$160.00	\$160.00
24.	REMOVE AND DISPOSE OF EXISTING MANHOLE #D-202 AND EXISTING 30" H.D.P.E. STORM SEWER, COMPLETE IN PLACE	LS	1	\$840.00	\$840.00
25.	REMOVE AND DISPOSE OF EXISTING OUTFALL, COMPLETE IN PLACE	LS	1	\$940.00	\$940.00
26.	REMOVE AND DISPOSE OF 8" BRICK WALL PLUG #D-1000 AND CONNECT PROPOSED 60" R.C.P. STORM SEWER, COMPLETE IN PLACE	LS	1	\$405.00	\$405.00
27.	BORE AND JACK OR AUGER SECTION FOR 60" RCP STORM SEWER INCLUDING DRY AND WET CONDITIONS, ALL DEPTHS, (DOES NOT INCLUDE RCP), COMPLETE IN PLACE	LF	7	\$175.00	\$1,225.00
28.	CONSTRUCT PROPOSED TYPE 'C' MANHOLE #D-202A OVER EXISTING 30" RCP STORM SEWER, COMPLETE IN PLACE	EA	1	\$3,100.00	\$3,100.00

**BID TABULATION FOR:**

CONSTRUCTION OF THE WATER, SANITARY SEW  
 TO SERVE TAVOLA SECTION 27  
 EAST MONTGOMERY COUNTY MUNICIPAL UTILIT  
 MONTGOMERY, COUNTY, TEXAS  
 FEBRUARY 11, 2020  
 LJA ENGINEERING, INC.  
 E. MURPHY  
 FEBRUARY 12, 2020  
 6966-1227 (9.2)

**BID OPENING DATE:**  
**BID OPENING LOCATION:**  
**TABULATION BY:**  
**TABULATION DATE:**  
**LJA JOB NO.**

7) PRECISE SERVICES, INC.

ITEM DESCRIPTION	UNIT	QTY	UNIT COST	TOTAL COST
29. TYPE 'E' INLET, COMPLETE IN PLACE	EA	1	\$3,850.00	\$3,850.00
<b>SUBTOTAL DRAINAGE FACILITIES ITEMS</b>				<b>\$664,886.30</b>
<b>MISCELLANEOUS ITEMS</b>				
1. ADJUST EXISTING MANHOLE RIM ELEVATION AS REQUIRED, (TO BE USED ONLY AT THE DIRECTION OF THE ENGINEER), COMPLETE IN PLACE	EA	1	\$315.00	\$315.00
2. STORMWATER POLLUTION INSPECTION REPORTS CONDUCTED ON A WEEKLY BASIS ACCORDING TO TCEQ PERMIT, COMPLETE IN PLACE	LS	1	\$345.00	\$345.00
3. DEDUCT FOR DAMAGE TO TREES OUTSIDE CLEARING LIMITS OR MARKED FOR PRESERVATION, COMPLETE IN PLACE	EA	0	(\$1,000.00)	\$0.00
4. DEDUCT FOR DAMAGE TO OWNER INSTALLED EROSION CONTROL FENCE, COMPLETE IN PLACE	LF	0	(\$2.00)	\$0.00
<b>SUBTOTAL MISCELLANEOUS ITEMS</b>				<b>\$660.00</b>
<b>BID SUMMARY</b>				
SUBTOTAL WATER ITEMS				\$95,534.60
SUBTOTAL SANITARY SEWER ITEMS				\$161,422.90
SUBTOTAL DRAINAGE FACILITIES ITEMS				\$664,886.30
SUBTOTAL MISCELLANEOUS ITEMS				\$660.00
<b>TOTAL AMOUNT BID</b>				<b>\$922,503.80</b>

LJA Engineering, Inc.